

FITTING INSTRUCTIONS

BP5190029L/R - USA

BP5190032L/R - ROW

TOYOTA PRADO 250 MY24+ FRONT

WARNING

- ◆ This product must be installed exactly as per these instructions using only the hardware supplied.
- ◆ In the event of damage to any suspension component, contact your nearest authorised ARB stockist. Repairs or modifications to the suspension system components must not be attempted.
- ◆ Do not use this product for any vehicle make or model, other than those specified by ARB.
- ◆ Do not remove labels from suspension components.
- ◆ This product or its fixing must not be modified in any way.
- ◆ The installation of this product may require the use of specialized tools and/or techniques
- ◆ It is recommended that this product is only installed by trained personnel
- ◆ These instructions are correct as at the publication date. ARB Corporation Ltd. cannot be held responsible for the impact of any changes subsequently made by the vehicle manufacturer
- ◆ During installation, it is the duty of the installer to check correct operation/clearances of all components
- ◆ Work safely at all times

Note: These fitting instructions should be read in conjunction with the vehicle workshop manual.

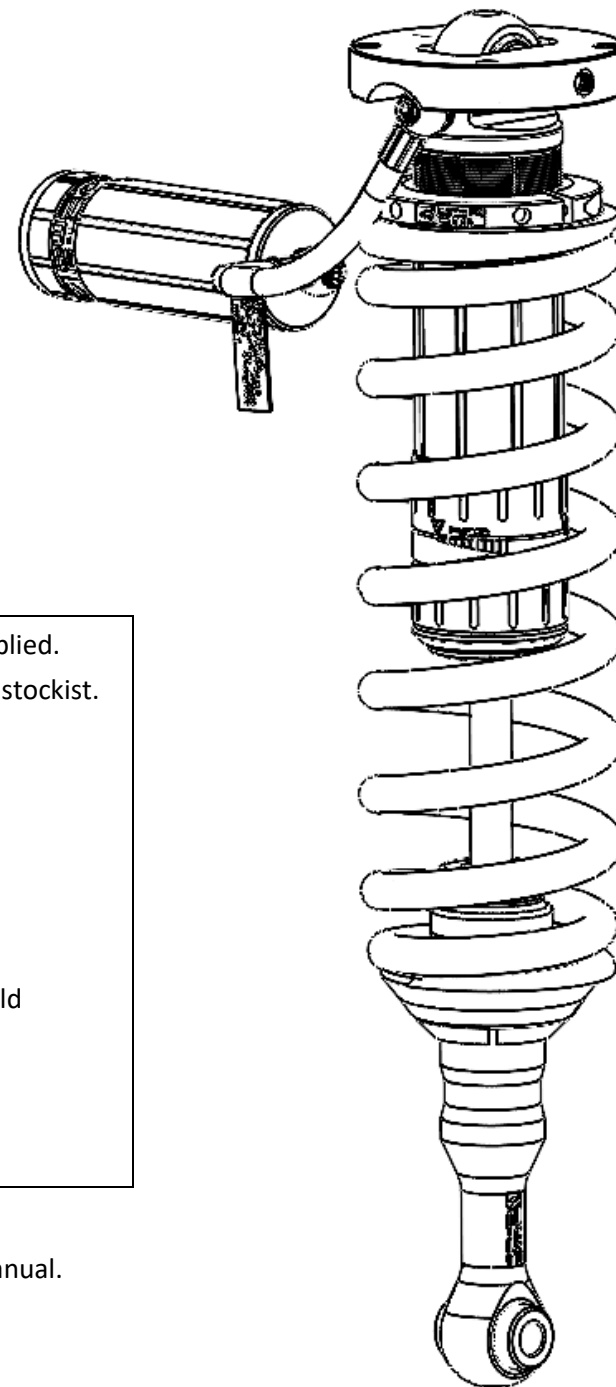

FITTING KIT CONTENTS – VM80010091

Item	Description	Qty.
1	BRKT RESI PRADO 250 24+ FR RH	1
2	BRKT RESI PRADO 250 24+ FR LH	1
3	RESERVOIR CLAMP	2
4	BP51 FASTENER KIT PRADO 250 24+ FR	1
4.1	M10 BOLT	8
4.2	M6 BOLT	4
4.3	M6 WASHER	4
4.4	M6 NYLOC NUT	4
4.5	M8 FLANGE BOLT	4
4.6	M8 CAGE NUT	4
4.7	NUT PLATE	4
5	TOOL: ADJUSTER TOOL	1

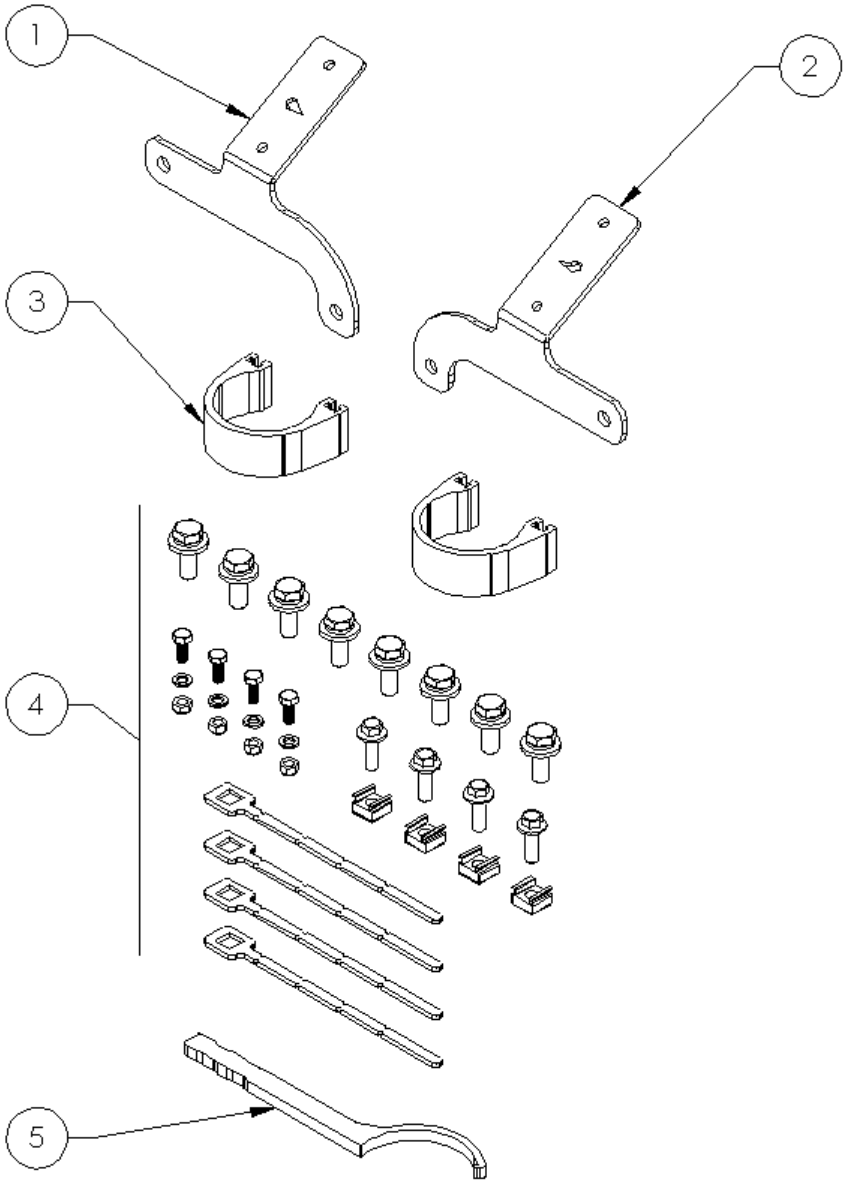

DAMPER PREPARATION

Before fitment the spring preload may need to be adjusted to suit your front accessory fitment and desired ride height.

Use workshop tool kit **VM80020001** to aid spring adjustment.

BP5190029L/R - The spring preload is set at the factory to 20mm as shown by the diagram. This aims to achieve 75mm increase in ride height over OE when no accessories are fitted.

BP5190032L/R - The spring preload is set at the factory to 10mm. This aims to achieve 50mm increase in ride height over OE when no accessories are fitted.

It is required to set the preload before the strut assembly is fitted to the vehicle. Use a spring compressor to compress the spring, loosen the pinch bolt on the preload ring and adjust to the desired setting. Tighten the pinch bolt and remove the strut assembly from the spring compressor.

As a guide, for **BP5190029L/R** set the preload as specified below to achieve 75mm lift over OE. For **BP5190032L/R** the preload specified will achieve 50mm lift.

Front accessories	029L/R Preload	032L/R Preload
Bar, winch +	30mm	25mm
Bar & winch	25mm	20mm
No accessories	20mm	10mm

Spring preload must only be adjusted when a spring compressor is used to take load off the preload ring.

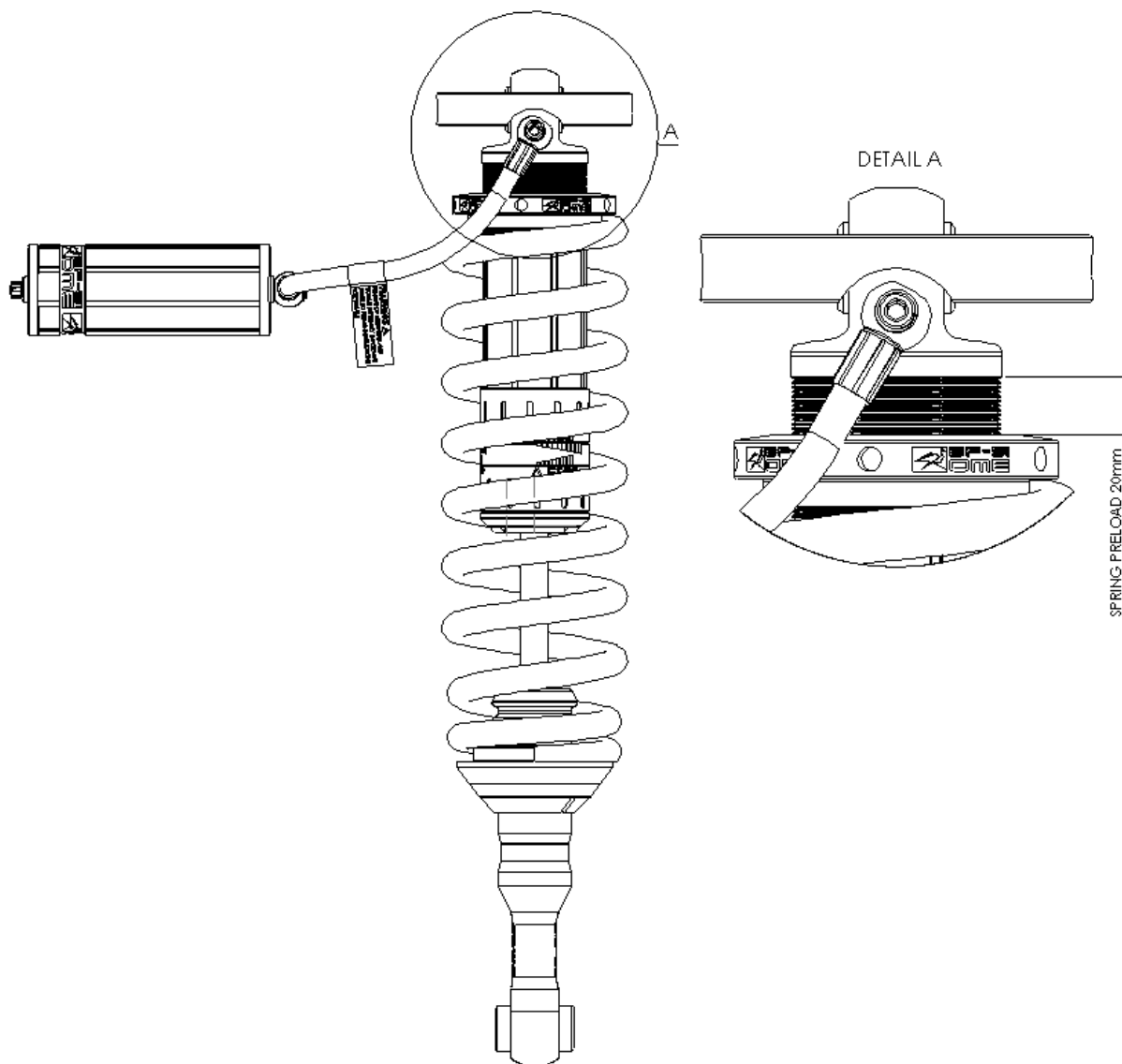

DAMPER MOUNTING SEQUENCE

1. Remove front wheels.
2. Disconnect tie rods from upright.
3. Loosen and remove lower strut bolt.
4. Loosen strut top hat nuts.
5. Disconnect damper loom (where applicable)
6. Lever lower strut off mount pin.
7. Remove strut top hat nuts.
8. Remove strut.

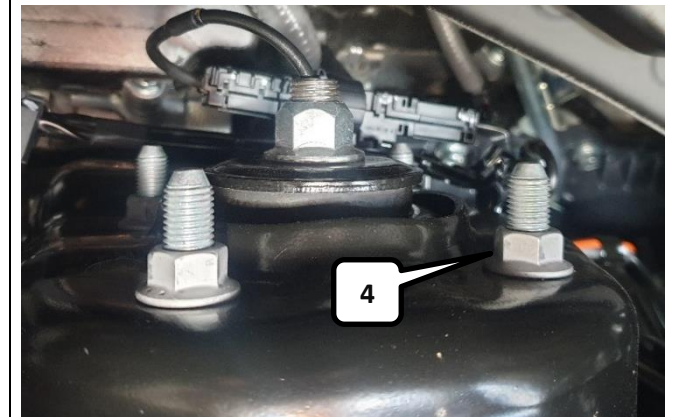
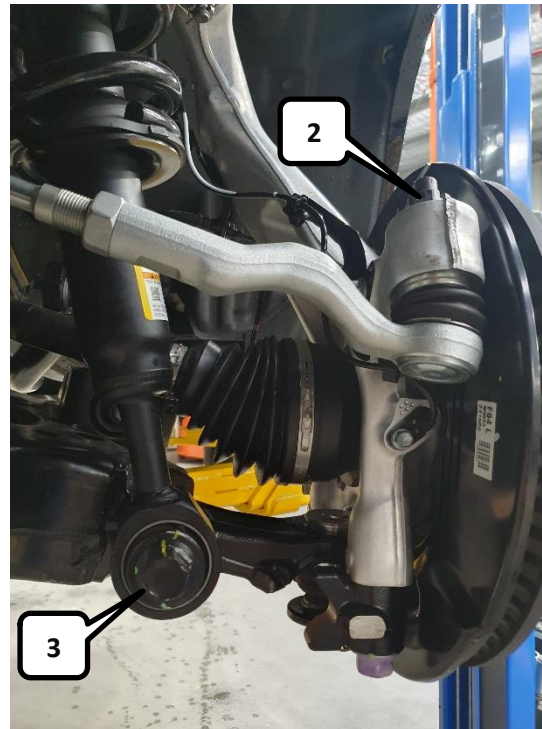

LHS SHOWN, RHS IDENTICAL

DAMPER MOUNTING SEQUENCE

1. Fit the damper and secure the top mount with the M10 hardware supplied. Secure finger tight. (LH shown)
2. When mounted in the vehicle, the hose and reservoir should be towards the front of vehicle.
3. Fit bottom mount to lower control arm.
4. Secure bottom mount using original bolt. **Torque to 250Nm.**
5. Tighten top mount bolts to **44Nm.**
6. Reconnect tie rod to upright and torque nut to **80Nm** and re-insert split pin.

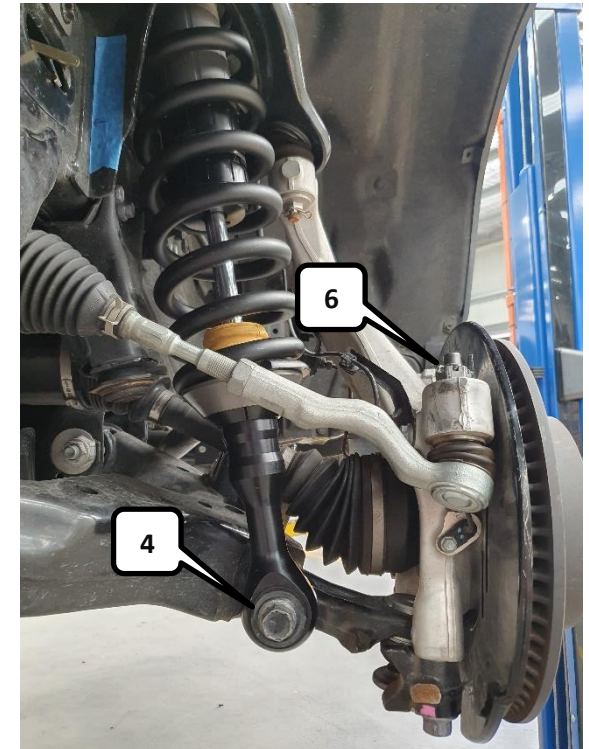
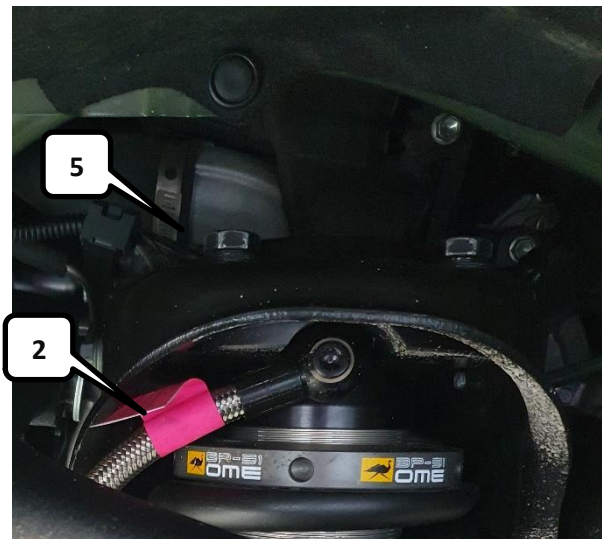

RESERVOIR MOUNTING SEQUENCE

1. Remove the plastic splash guard and small blanking cap.
2. Lightly fasten the reservoir clamp onto the bracket as shown and fit over the reservoir.
3. Secure the reservoir in place with the clamp approximately 35mm from the Banjo end, torque nuts to **12Nm**.
4. Fit the cage nuts in to the nut plates. Bend nut plates to match up with the splash guard clip holes. Feed into chassis through small blanking cap hole.
5. Fit the mounting bracket to the chassis, using the supplied flange bolts to secure it into place. Tighten securely.
6. Ensure the hose is well routed from the damper body cap to the reservoir without kinks and with clearance to the upper control arm.

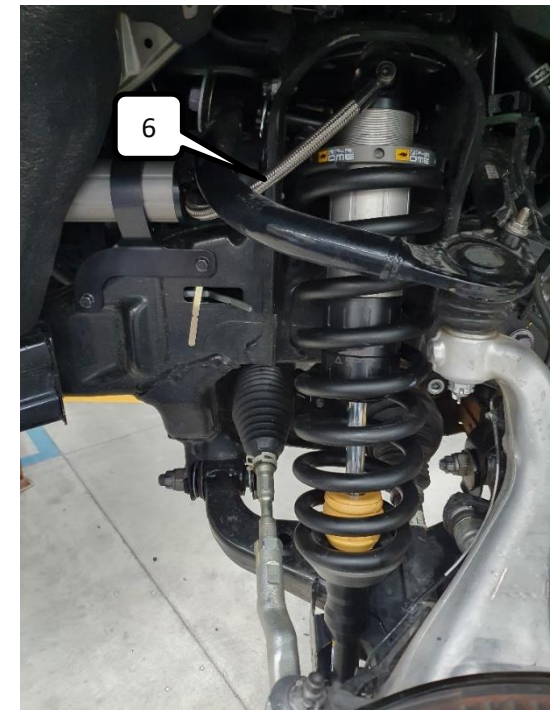
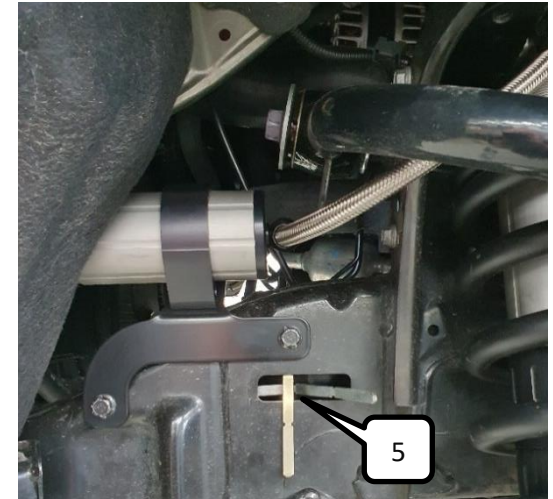
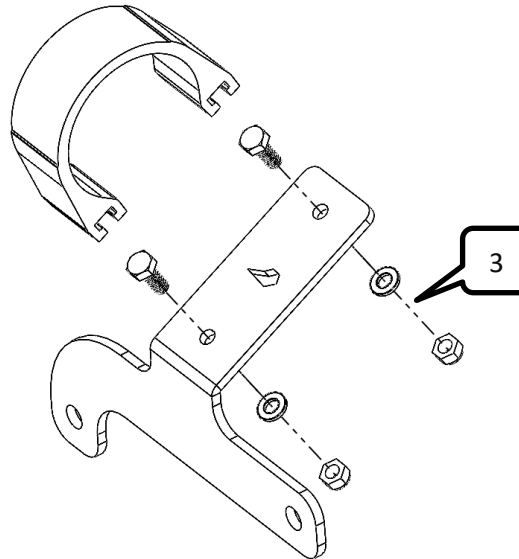
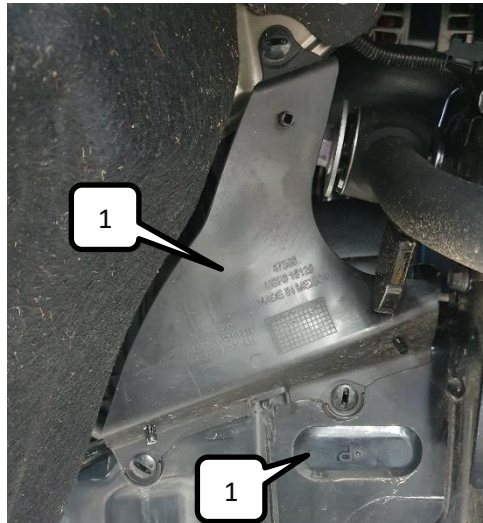

DAMPING ADJUSTMENT

These dampers have been set in the factory to be used for a vehicle with no accessories fitted.

If your accessory fitment differs, use the table below as a guide for recommended Compression and Rebound adjuster settings.

Refer to the Owner’s Manual for more information.

Front Accessories	Compression	Rebound
Factory setting	0	4
No accessories	0-3	0-3
Bar only	2-6	2-6
Bar & Winch	5-10	5-10

SPARE PARTS

Refer to Service & Parts Manual, section:
- BP-51 S&P 3.1-BP5190029L&R
- BP-51 S&P 2.1-BP5190032L&R

