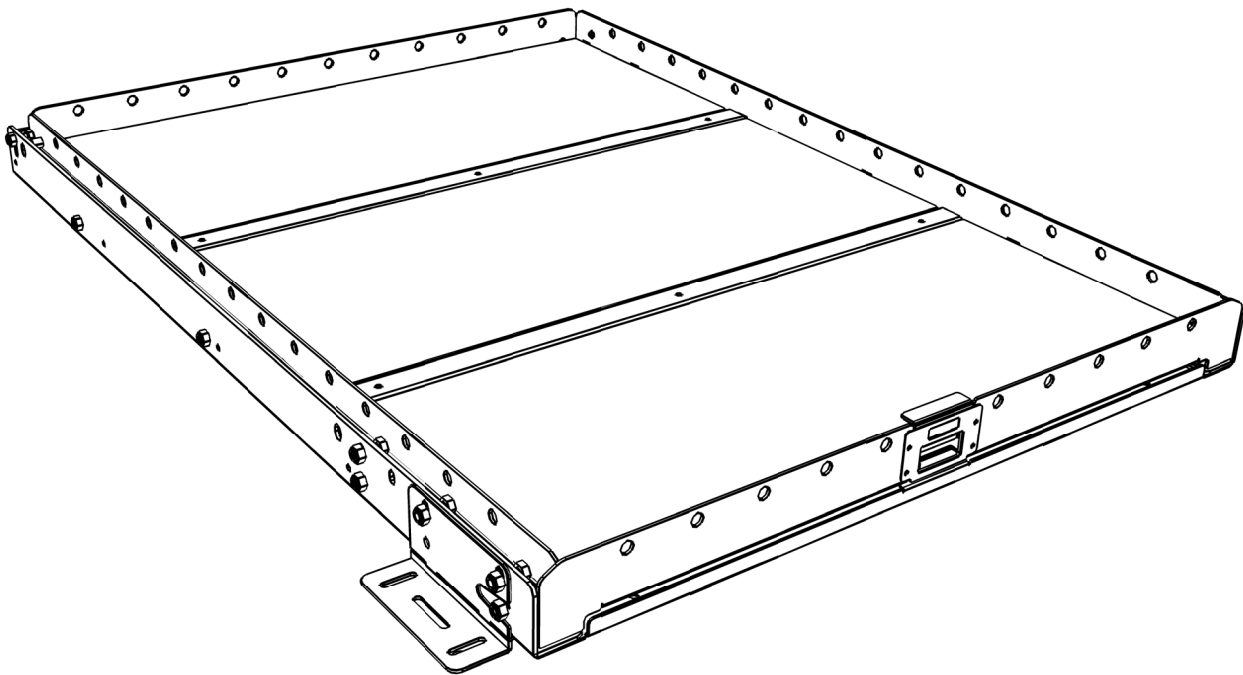

**FRONT RUNNER****CARGO SLIDE FOR PICK-UP  
SMALL****ENG**

SSBS005

**INSTALL TIME: 45 mins**

### **IMPORTANT WARNING!**

**IT IS CRITICAL THAT ALL FRONT RUNNER PRODUCTS BE PROPERLY AND SECURELY ASSEMBLED AND ATTACHED TO YOUR VEHICLE. IMPROPER ATTACHMENT COULD RESULT IN AN AUTOMOBILE ACCIDENT, AND COULD CAUSE SERIOUS BODILY INJURY OR DEATH TO YOU OR TO OTHERS. YOU ARE RESPONSIBLE FOR ASSEMBLING AND SECURING ALL FRONT RUNNER PRODUCTS TO YOUR VEHICLE, CHECKING THE ATTACHMENTS PRIOR TO USE, AND PERIODICALLY INSPECTING THE PRODUCTS FOR ADJUSTMENT, WEAR, AND DAMAGE. THEREFORE, YOU MUST READ AND UNDERSTAND ALL OF THE INSTRUCTIONS AND CAUTIONS SUPPLIED WITH YOUR FRONT RUNNER PRODUCT PRIOR TO INSTALLATION OR USE. IF YOU DO NOT UNDERSTAND ALL OF THE INSTRUCTIONS AND CAUTIONS, OR IF YOU HAVE NO MECHANICAL EXPERIENCE AND ARE NOT THOROUGHLY FAMILIAR WITH THE INSTALLATION PROCEDURES, YOU SHOULD HAVE THE PRODUCT INSTALLED BY A PROFESSIONAL INSTALLER OR OTHER QUALIFIED PERSONNEL.**

# 1 GET ORGANIZED...

Here is what you are looking at:

Item#	Quantity	Description
1	1	CARGO SLIDE
2	9	M6 x 40 HEX BOLT
3	5	M6 x 25 HEX BOLT
4	1	M6 x 25 COUNTERSUNK BOLT
5	6	ALUMINIUM SPACER
6	10	M5 RIVNUT
7	9	M6 x 30 FLAT WASHER
8	1	M10 FLAT WASHER
9	9	M6 SPRING WASHER
10	2	M8 NYLOC NUT

You will need:

- ☐ 10 mm Flat or Socket Wrench
- ☐ 17 mm Flat & Socket Wrench
- ☐ 4 mm Hex Key
- ☐ Suitable Marking Pen
- ☐ Measuring Tape
- ☐ 4 mm & 9 mm Drill Bit
- ☐ Drill Machine
- ☐ Rivnut Tool
- ☐ a Friend

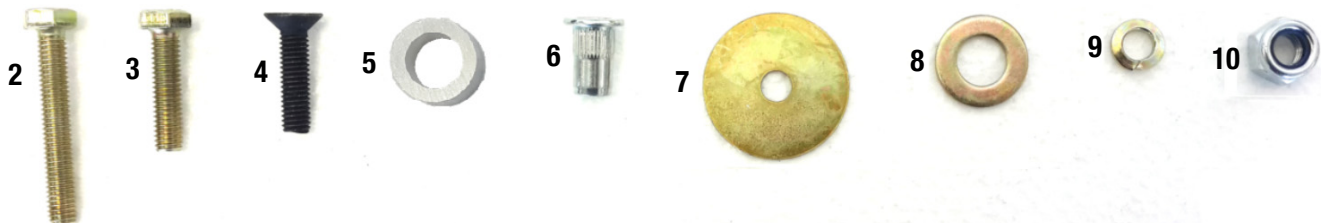
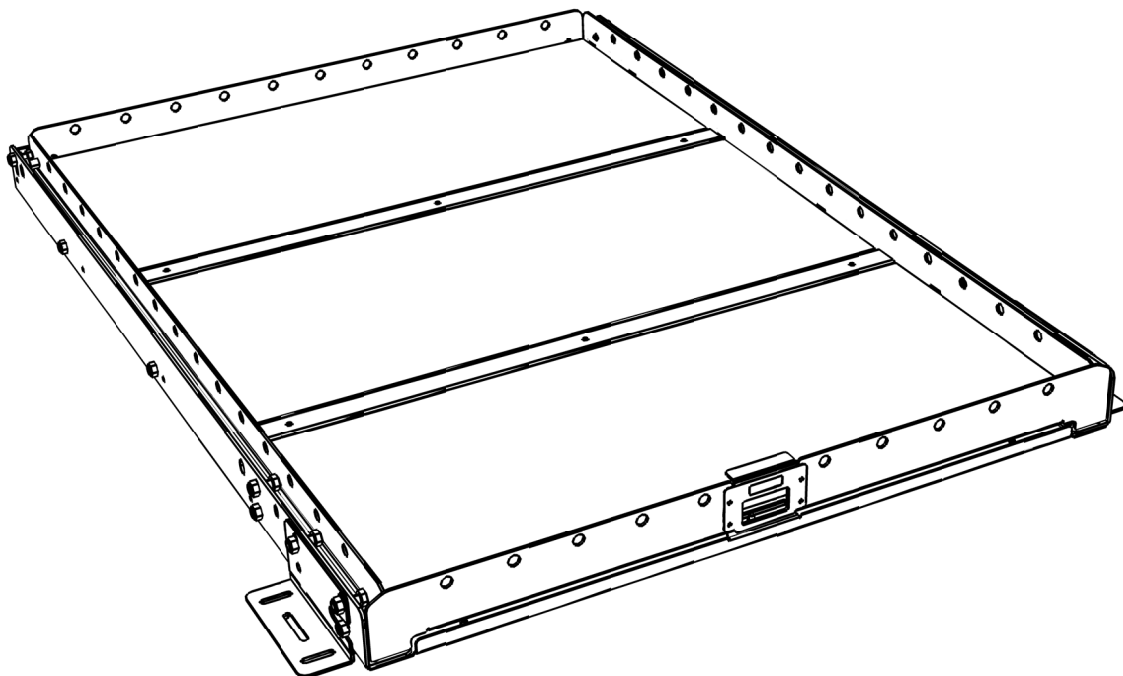

( A ) Familiarize yourself with the parts and then step away from the work area and read through these instructions from beginning to end. Take a moment as a little prep now may save you a lot of time later.

## 2 INSTALL SLIDE

- ( A ) Looking at both the left and right rear corners of the Cargo Slide (Item 1), loosen and remove the rubber stopper. This is done by gripping the stopper to prevent it from turning and removing the M6 Button Head Bolt as indicated. Once removed keep in a safe place as you will need to replace them at a later stage.

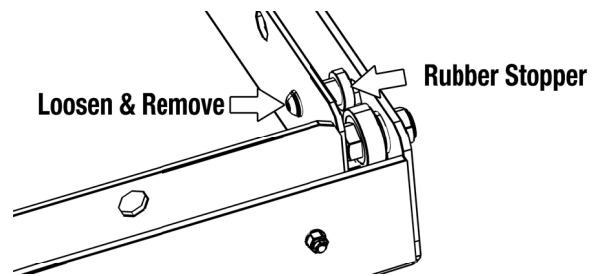

- ( B ) Place the Cargo Slide into the vehicles' load bed. Carefully pull the "Tray" free from the Frame and store in a safe place until required later.

- ( C ) Position the Frame, front to back and left to right. Load beds vary from manufacturer to manufacturer, so the exact positioning of the Frame will vary from vehicle to vehicle. It is preferable to get all mounting points in the center of the raised sections/ribs that run the length of the load bed, however in the event of mounting points not lining up with raised sections, spacers have been provided (Item 5).

The Front Mounting Feet may be relocated backwards should it be required to obtain a better mounting position as shown.

Make sure you have closed the load beds' door to ensure that it does not make contact with the Frame. Once you are satisfied with the positioning of the Frame, mark the position of all the mounting points as indicated by the arrows onto the vehicles body. Select the best suited mounting point from A, B or C on the front foot and mark its position onto the vehicle.

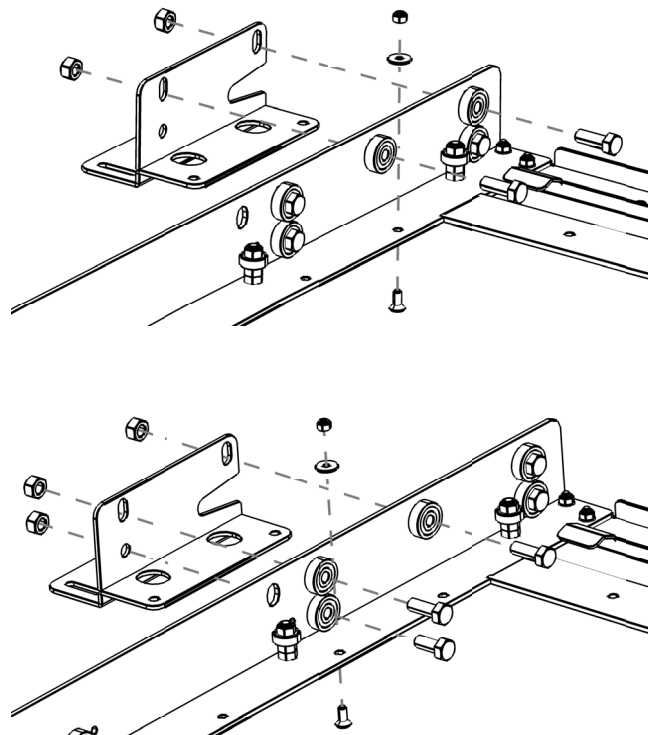
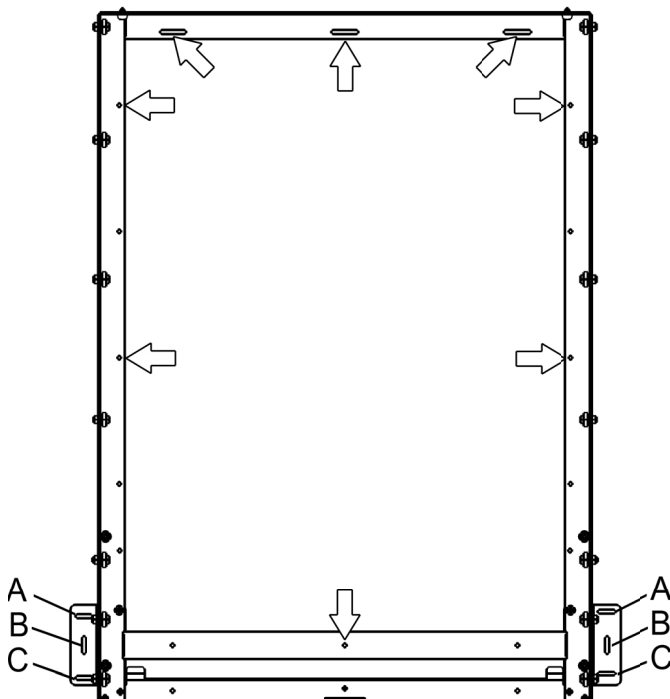

## 2 PREPARE FOR INSTALLATION CONT...

- ( D ) Remove the Frame from the load bed and drill a 4 mm pilot hole on each of your markings. Check the underside of the load bed before drilling to make sure that there is no piping or wiring in the way. Re-drill all of the pilot holes to 9 mm.

- ( E ) Insert and crimp a M6 Rivnut (Item 6) into each of the 9 mm holes drilled in Step 2D.

- ( F ) Place the Frame back onto the load bed and secure in position using the fasteners and spacers supplied. The Spacers (Item 5) are to be used when the mounting point falls in a "dip" and not on a rib by placing it over the Rivnut so that the frame rests on the Spacer.

When securing the front center mounting of the frame use the M6 x 25 Countersunk Screw and M10 Flat Washer (Items 4 & 8).

- ( G ) Refer to Step 2A, refit the Tray and Stoppers. Once refitted Check that the push to close latch engages fully and that the slide is secure. If necessary adjust accordingly using the M6 Bolt, once satisfied that latch engages fully, lock bolt in place with the M6 Lock Nut. (Position of M6 Bolt indicated in Step 2H.)

- ( H ) Congratulations, you have completed your installation. Take a step back and admire your work. Good Job!

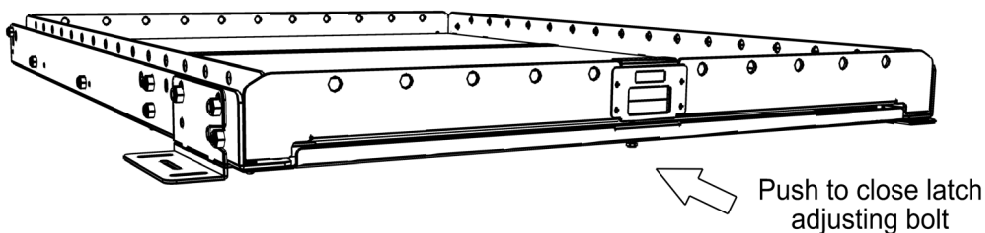

## 3 INSTALL OTHER VEHICLE AND RACK ACCESSORIES

- ( A ) Now's the time to visit your favorite Front Runner dealer in person or online.