

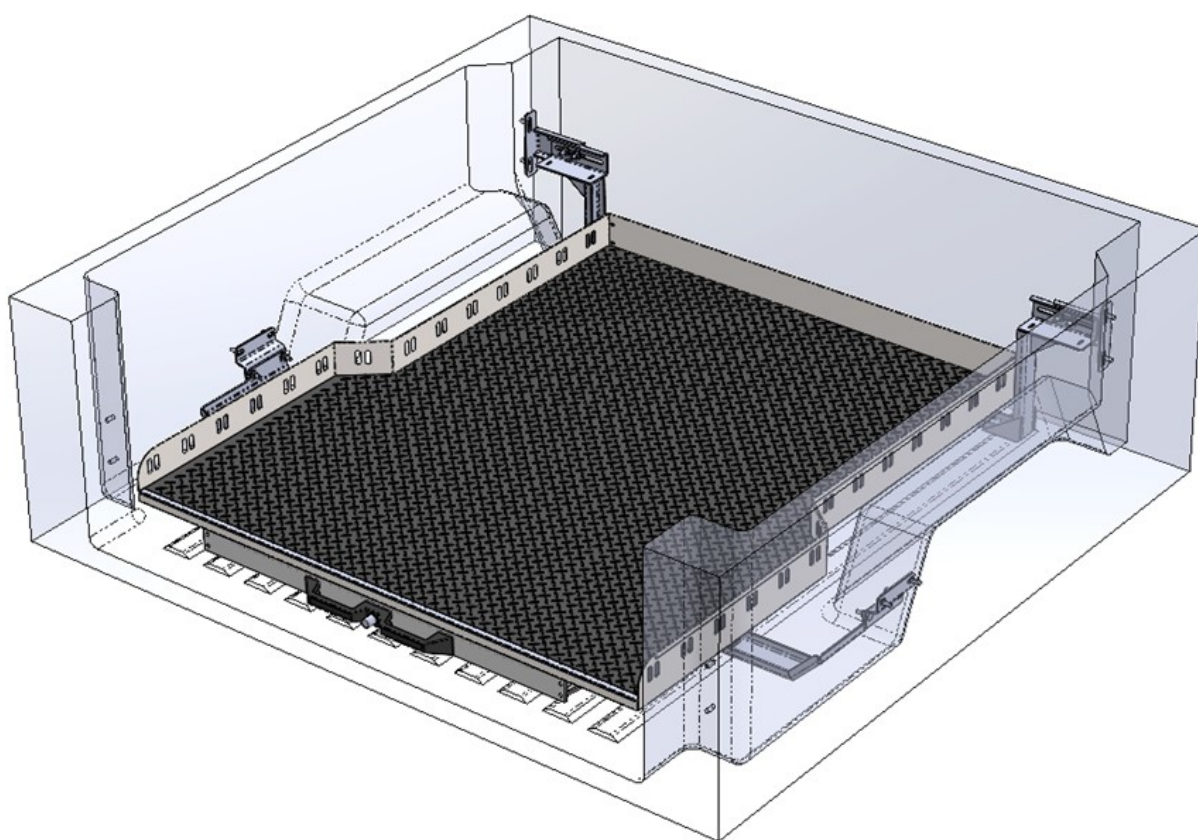

INSTALLATION INSTRUCTIONS

T-SLIDE - 2023 FORD RANGER & VW AMAROK



IMPORTANT WARNING!



Before you start installation, please take a moment to familiarise yourself with this installation instruction booklet and components received.

It is critical that all products are properly secured in your vehicle. Improper attachment could result in a vehicle accident and could cause serious bodily injury or death.

You are responsible for assembling and securing all products to your vehicle, checking the attachments prior to use. Inspect periodically for adjustment, wear and damage, and keep rails well lubricated.



ASSEMBLY KIT INCLUDES

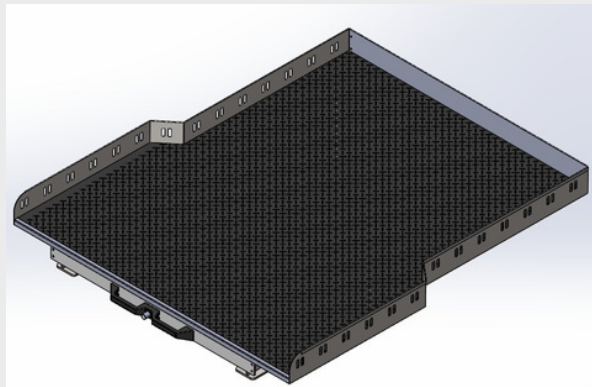

T-SLIDE

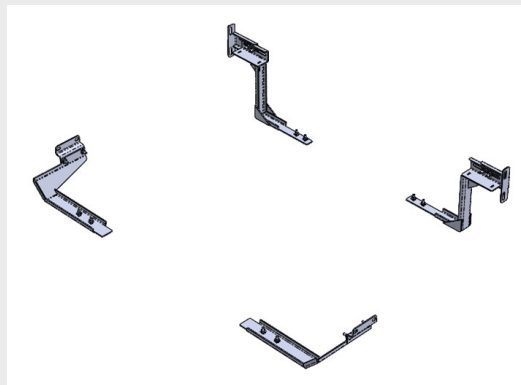

T-SLIDE BRACKETS



12 X: M8 NYLOC NUT



12 X: M8 WASHER

TOOLS REQUIRED

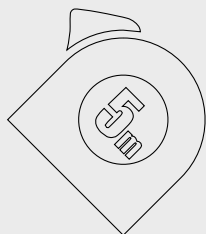

13mm

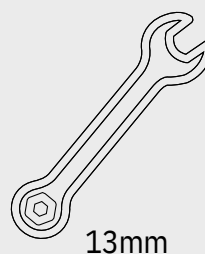

13mm

TERMINOLOGY

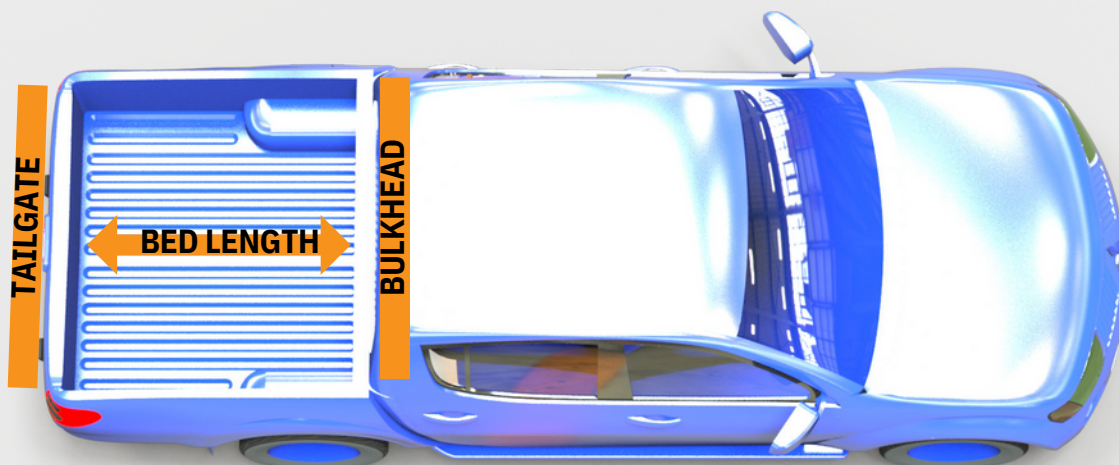

1.1

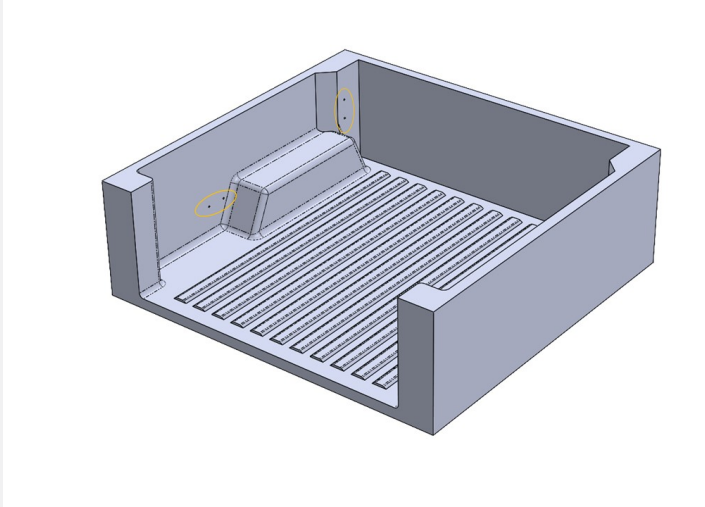

LOCATE THE MANUFACTURERS TIE DOWN POINTS AND REMOVE ANY HOOKS THAT ARE ATTACHED.

KEEP THE BOLTS FROM THE HOOKS, THESE WILL BE RE-USED IN THE NEXT STEPS.

1.2

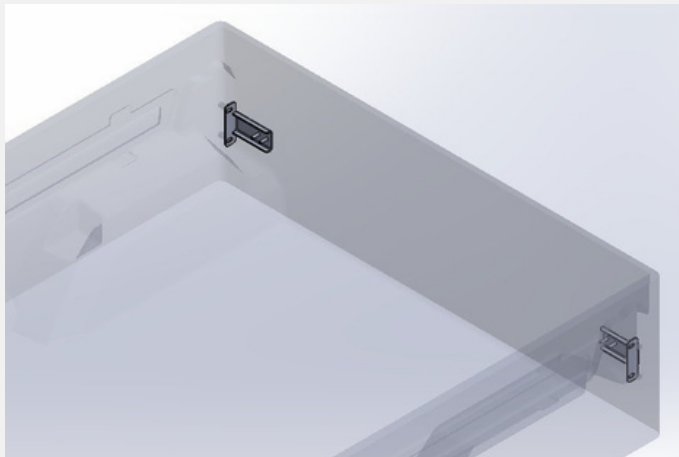

USING THE BOLTS JUST REMOVED, LOOSELY ATTACH THE BULKHEAD BRACKETS IN THE POSITIONS SHOWN.

1.3

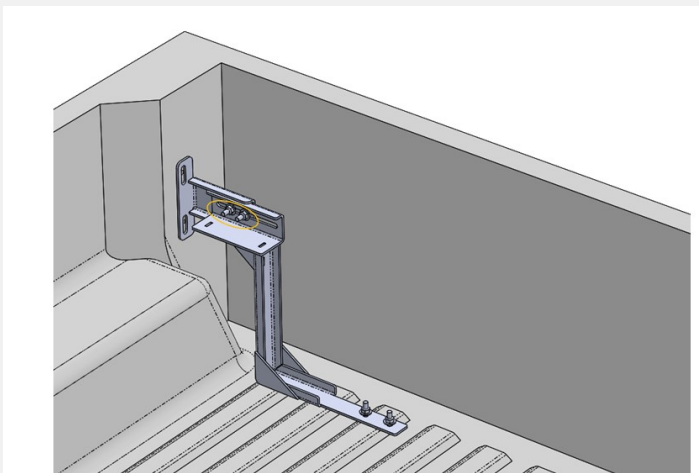

USE THE M8 NYLOC NUT WITH WASHER TO LOOSELY CONNECT THE SECOND BULKHEAD BRACKET TO THE FIRST.

REPEAT ON THE OPPOSITE SIDE.

1.4

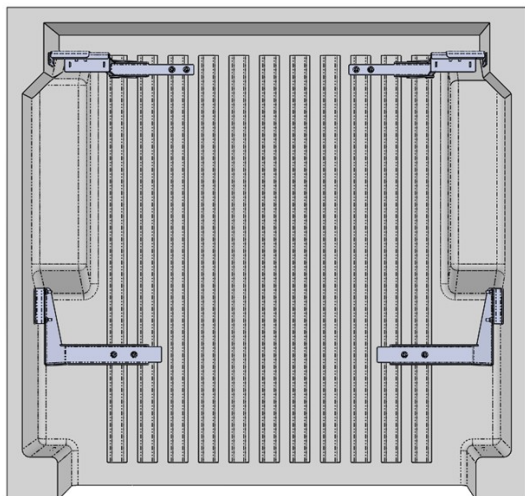

REPEAT STEP 1.2 FOR THE TAILGATE BRACKETS.

2.1

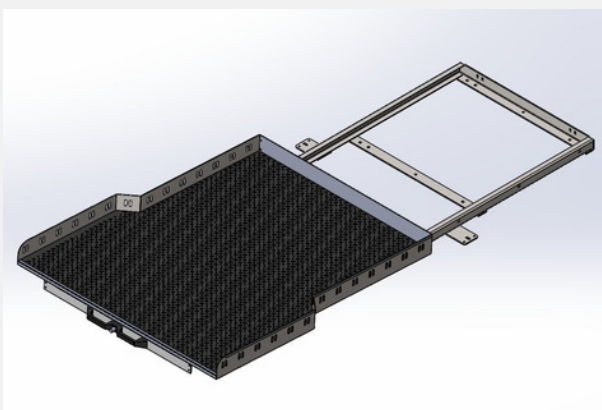

SEPARATE THE TOP OF THE T-SLIDE FROM THE BASE, IT WILL HAVE BEEN SHIPPED IN THE ASSEMBLED STATE.

TO SEPARATE PUSH THE BUTTON ON THE HANDLE, PULL OUT, NEAR THE END OF THE TRACK, LIFT THE TOP FRAME UP (KEEP THE BUTTON COMPRESSED).

PLACE THE TOP FRAME TO ONE SIDE.



WARNING!

Do not lift on your own!
Minimum of 2 people required to lift.

2.2

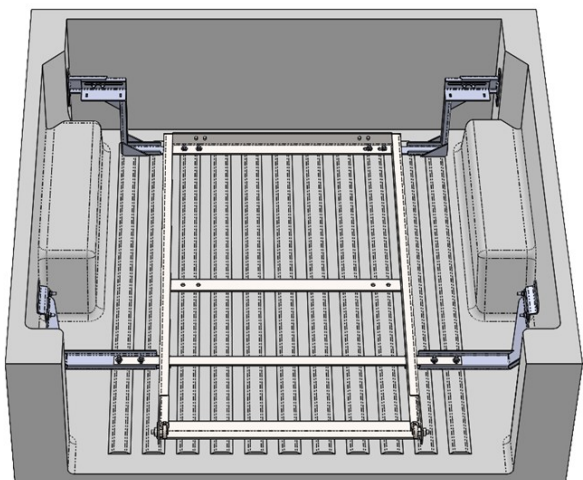

PLACE THE BOTTOM FRAME IN THE BED, LOCATING ON THE BOLTS IN THE BULKHEAD BRACKETS AND TAILGATE BRACKETS

USE THE NYLOC NUTS WITH WASHERS TO LOOSELY SECURE THE FRAME TO THE BRACKETS

2.3

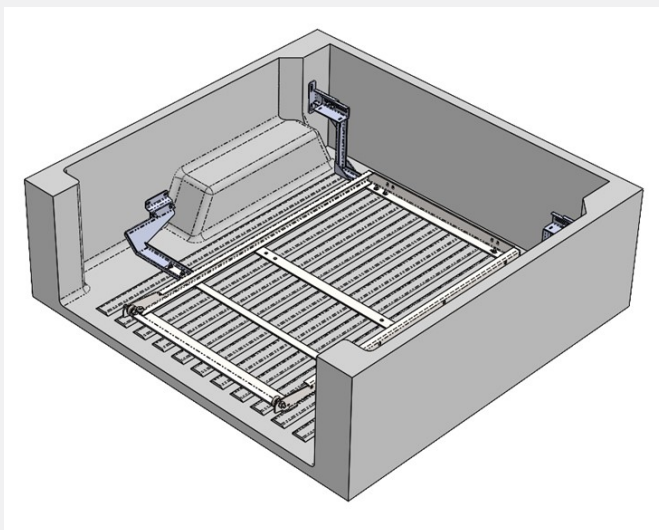

USE A TAPE MEASURE TO ENSURE THE FRAME IS CENTRED, TIGHTEN ALL FIXINGS.

2.4

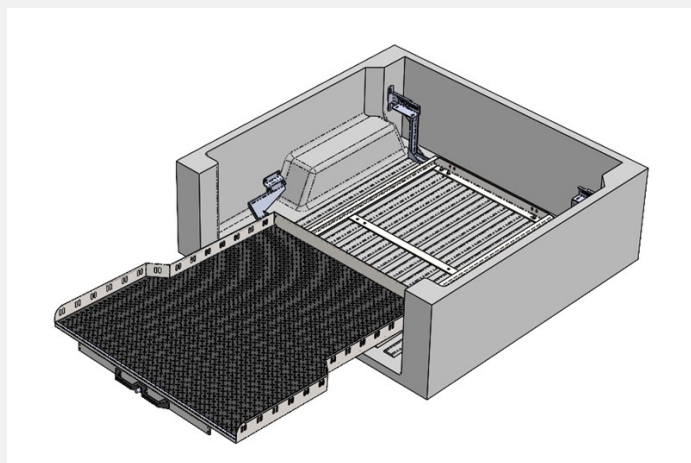

REVERSE STEP 2.1 TO ATTACH THE TOP FRAME TO THE BASE. (COMPRESS THE BUTTON ON THE HANDLE, TILT, DROP IN BETWEEN THE TRACKS, GENTLY LOWER AND PUSH BACK).

YOUR INSTALLATION IS NOW COMPLETE.



WARNING!
Risk of trapping hand/finger.

