



RHINO-RACK

MS15-470 Short Multi Slide Extension Ladder System

Place these instructions in the vehicle's glove box after installation is complete.

Important: Please read these instructions carefully prior to installation.
 Please refer to your fitting instruction to ensure that the roof racks are installed in the correct locations.
 Check the contents of this kit before commencing fitment and report any discrepancies.
 Place these instructions in the vehicle's glove box after installation is complete.

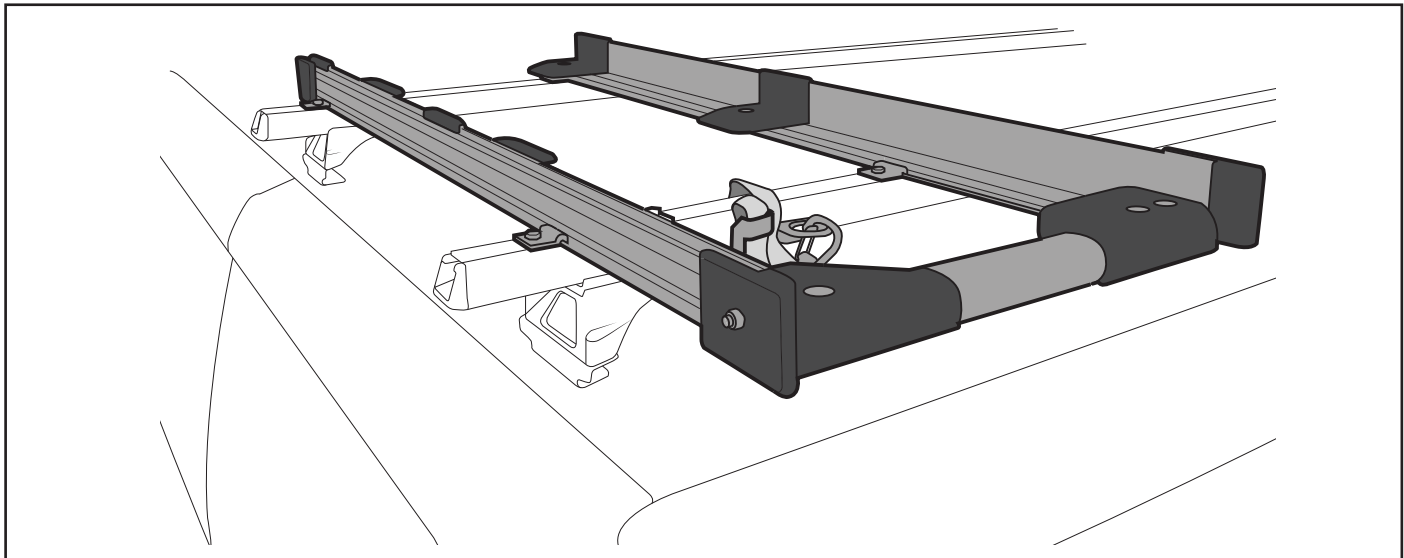

Care Instruction: Wash vehicle roof prior to installing Rhino roof racks.

Important Information

Maximum carrying capacity: 35kg (including frame and roof bars)

Recommendations: It is essential that all bolt connections be checked after driving a short distance when you first install your crossbars. Bolt connections should be checked again at regular intervals (probably once a week is enough, depending on road conditions, usage, loads and distances travelled). You should also check the crossbars each time they are re-fitted. Make sure to fasten your load securely. Please ensure that all loads are evenly distributed and that the centre of gravity is kept as low as possible.

Use only non-stretch fastening ropes or straps. Sensitivity to cross winds, behaviour in curves and braking.
 The handling characteristics of the vehicle, changes when you transport a load on the roof. For safety reasons, we recommend you exercise extreme care when transporting wind-resisting loads; special consideration must be taken into account when braking.

Please remove cross bars when putting vehicle through an automatic car wash.

Load Ratings:

Maximum permissible load is 35kg per ladder rack.

Note for Dealers and Fitters:

It is your responsibility to ensure instructions are given to the end user or client.

Tab Kit Required (Sold as separate).		Strap Kit Required (Sold as separate).		Hoop Kit Required (Sold as separate).	
Vortex Crossbar	1 x RLTABM6-8	Vortex Crossbar	SLS5	Vortex Crossbar	SUH
Heavy Duty Crossbar	1 x RLTAB-8	Heavy Duty Crossbar	RLS5	Heavy Duty Crossbar	RUH

Rhino-Rack
 3 Pike Street, Rydalmere,
 NSW 2116, Australia.
 (Ph) (02) 9638 4744
 (Fax) (02) 9638 4822

Document No: R702
 Prepared By: Kayle Everett
 Authorised By: Chris Murty

Fit Time: 30min
 Issue No: 03
 Issue Date: 01/05/2017

These instructions remain the property of Rhinorack Australia Pty Ltd and may not be used or changed for any other purpose than intended.



MS15-470 Short Multi Slide Extension Ladder System

Parts List:

No.	ID	Description	Qty
A MSGPK Guide Plate Kit			
1	B096	M8 x 20mm T-Bolt	6
2	M068	Front Ladder Rail End Cap	2
3	M069	Side Ladder Rail End Cap	4
4	W020	M8 x 17mm Flat Washer	6
5	N028	M8 Nyloc Nut	6
B MSB470			
6	A196	Bullnose Cross Bar 455mm	1
7	B096	M8 x 20 Steel T Bolt	2
8	N028	M8 Nyloc Nut	2
9	R013-160	PVC Extrusion	1
10	W020	M8 x 17 Flat Washer	2
C Ladder Rail + SUB0619			
11	A198	1.5m Multislide Rail	2
12	M070	Ladder Slide Flat	2
13	M071	Ladder Slide - Stepped	2
14	N013	M6 Nyloc Nut	4
15	W031	M6 x 16 Flat Washer	4
16	B095	M6 x 15 T Bolt	4
D MSRBK Multislide Rear Bullnose			
17	B095	M6 x 15 T Bolt	4
18	M066	Rear Bullnose - Left	1
19	M067	Rear Bullnose - Right	1
20	N013	M6 Nyloc Nut	4
21	W031	M6 x 16 Flat Washer	4
*E RLS5 Ladder Restrain Strap (sold separately)			
22	B003	M10 x 20 Hex Setscrew	1
23	B019	M8 x 16 Hex Setscrew	1
24	B024	M6 x 50 Hex Bolt Thread	1
25	C033	U-Section Strap Bracket	1
26	C087	Camlock Strap + Snap Hook	1
27	C122	RLS5 Snap Hook Bracket	1
28	N003	M8 Channel Nut	1
29	N013	M6 Nyloc Nut	1
30	N024	M10 Channel Nut	1
31	W021	M10 Shake Proof Washer	1
32	W033	M8 Shake Proof Washer	1
33	R702	Instructions	1

[A] MSGPK Guide Plate Kit

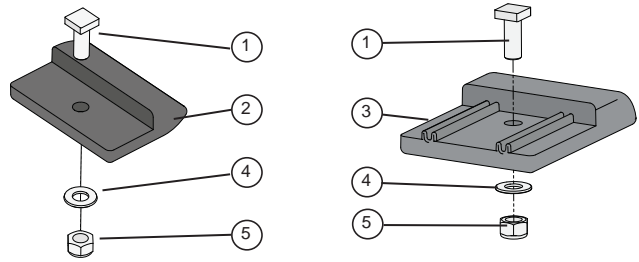

[B] MSB470

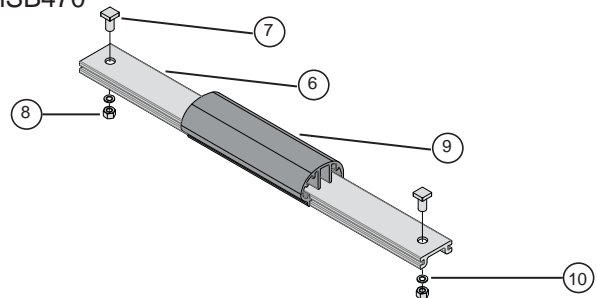

[C] Ladder Rail + SUB0619

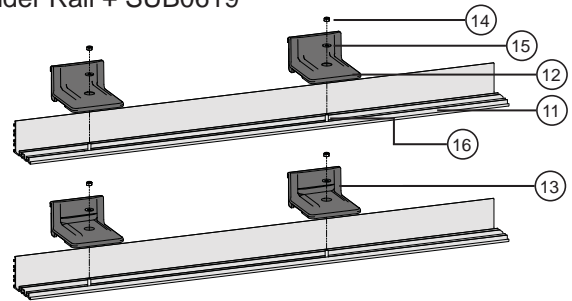

[D] MSRBK Multislide Rear Bullnose

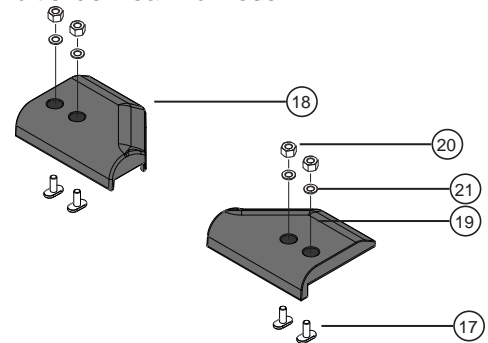

*[E] RLS5 Strap (sold separately)

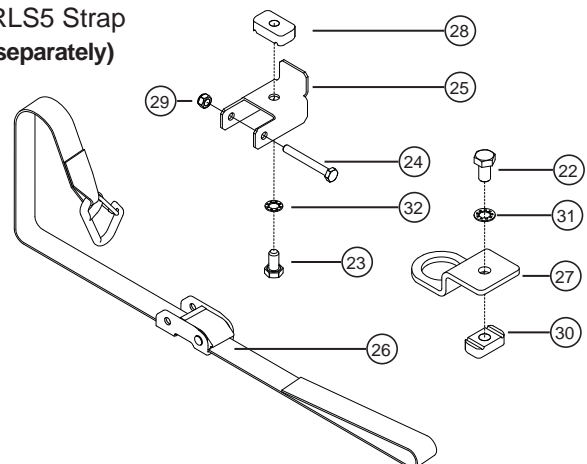



MS15-470 Short Multi Slide Extension Ladder System

Assembly

1

Slide 2 M6 T Bolts onto the ladder rail in the outer slot. Assemble the Pads for each rail. 2 x M071, flat washers and nyloc nuts for one and 2 x M070, flat washers and nyloc nuts for the other. Finger Tighten.

Note: Rail assembly must adhere the following sequence so that parts do not have to be removed fit others.

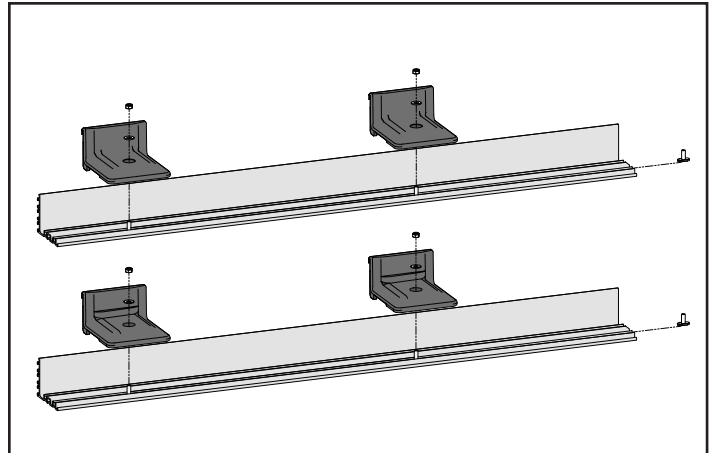

2

Front **ONLY**

Using the M8 x 20 T Bolts, flat washers and nyloc nuts, secure the Front [I] and Side [J] End Caps to each Ladder Rail [C] as shown.

Securely tighten T-Bolts with a 13mm Socket.

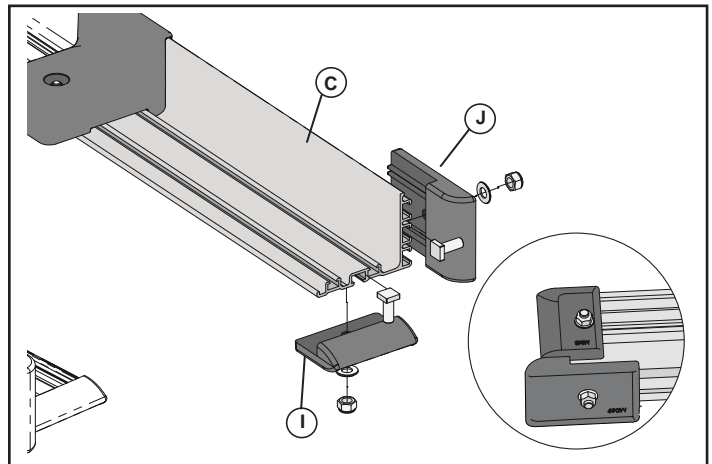

3

Slide an M6 T Bolt into slots on the base section of the rail as shown. Slide an M8 Steel T Bolt into the underside of each rail.

Place the left and right Bullnose over the T Bolts. Ensure the Bullnose is **fully located up against the end of the ladder rail**. Fix in place with M6 washers and nyloc nuts. Tighten with a 10mm socket.

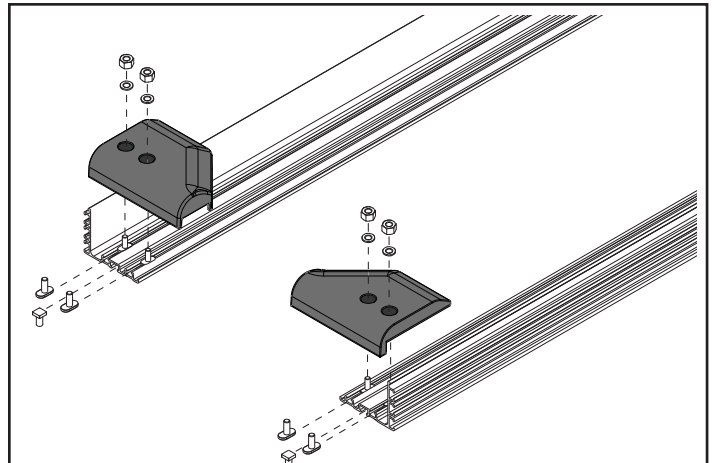

4

Using the M8 x 20 T Bolts, flat washers and nyloc nuts, Side End Caps to each Ladder Rail as shown.

Securely tighten T-Bolts with a 13mm Socket.

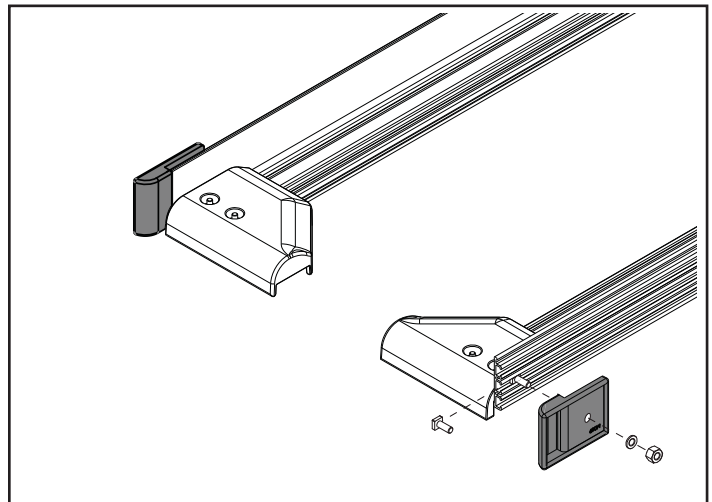



MS15-470 Short Multi Slide Extension Ladder System

5

Attach the MSB470 Bullnose Crossbar to the 2 M8 x 20 Steel T Bolts, installed in step 3.

Secure the crossbar with M8 washers and nyloc nuts. Tighten with a 13mm socket wrench.

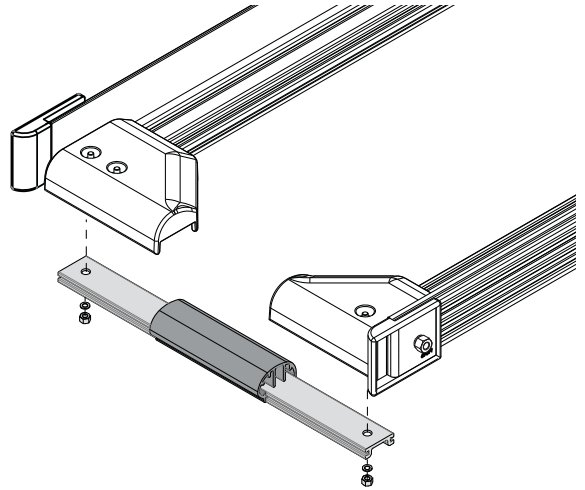

6

Note: RLTAB-8 (HD) or RLTABM6-8 (VA) required (sold as separate)

Position the MS15-470 Multi Slide Ladder Rack onto the vehicle's crossbars in the desired position. Be sure to allow clearance for the rear door of the vehicle.

Slide 4 channel nuts into the crossbars at the front and rear of the ladder rack. The assemblies provided in the chosen RLTAB kit will fix to these. The Tabs will lock onto the outer and inner edge of each ladder rail. When in position, tighten in place with a socket wrench.

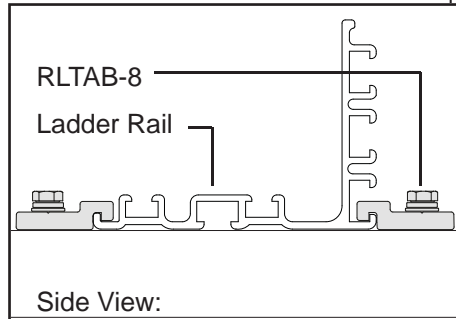
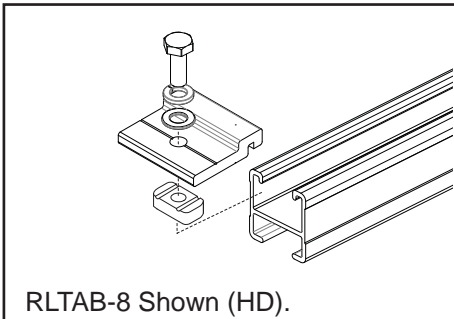
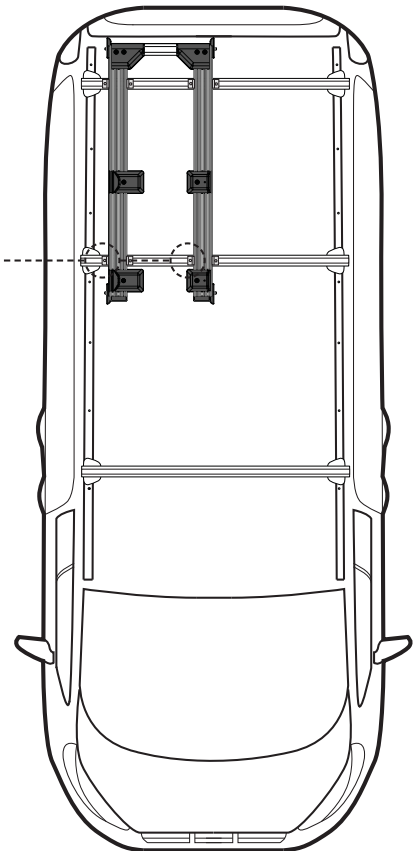

7

Adjust the positioning of the ladder slides as required. Tighten in place with a 10mm socket wrench.

Check all fixtures are secure before use.

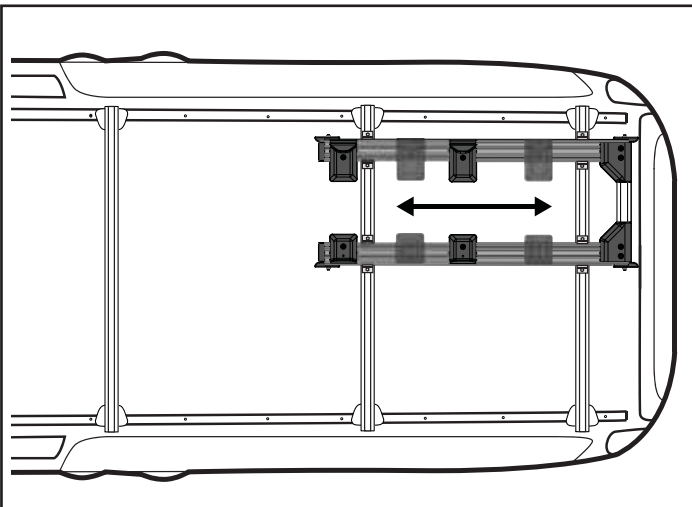



MS15-470 Short Multi Slide Extension Ladder System

8

RLS5 Ladder Restrain Strap (Recommended Fitment): Insert the camlock and hook bracket to the underside of the rear crossbar 15-20mm apart. Push the attachment bolts up and turn each bolt so that the channel nut is fully located across the cross bar as shown below. Position the Camlock and Hook bracket to suit the ladder. Tighten the bolts.

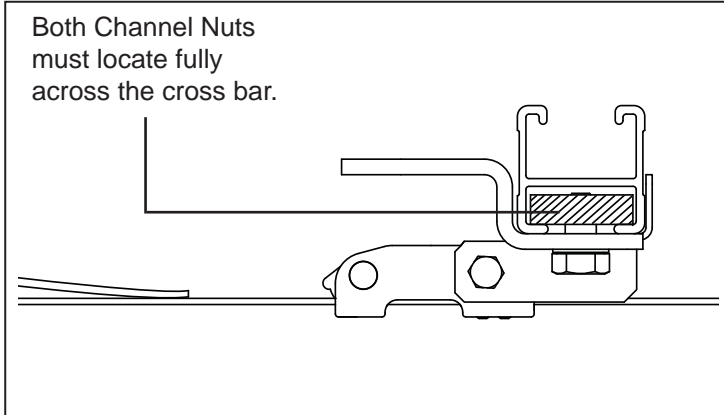
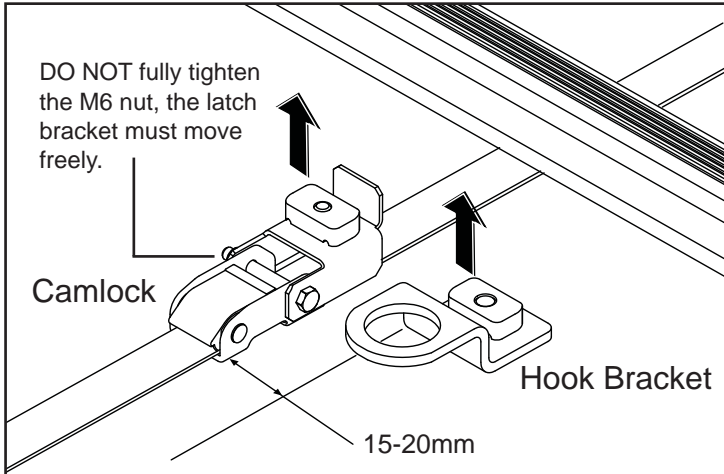

Wrap the snap hook end of the strap around the ladder rungs and crossbar ensuring the safety latch is fully closed. Pull strap to tighten. Check ladder is secure. To release tension, press the camlock latch and pull the strap back through the camlock, unhook the snap hook. When travelling without a ladder, locate the snap hook onto the hook bracket.

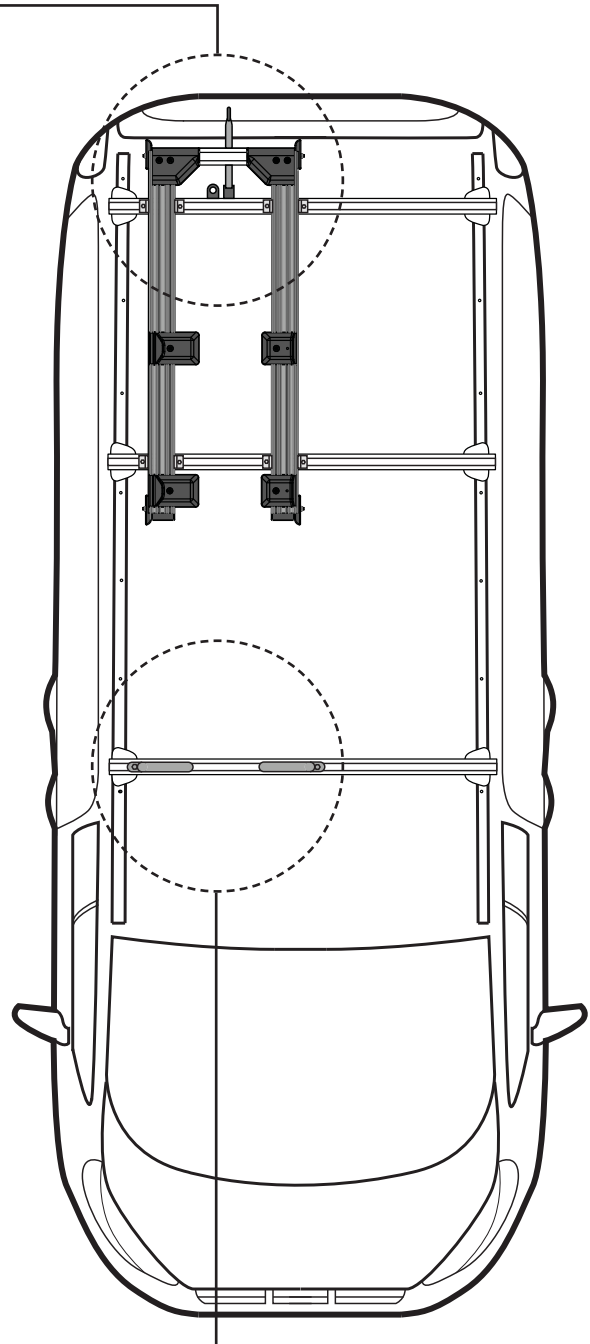
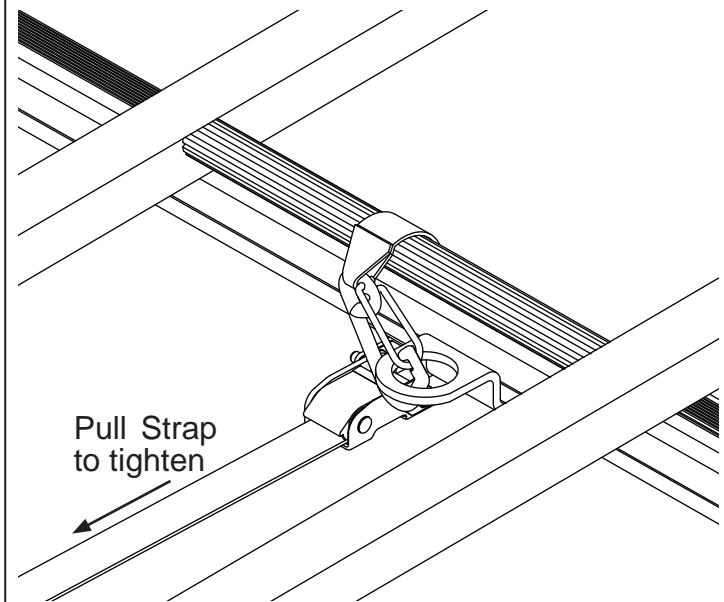

Ladder Hoop Kits sold separate.
RUH Kit - Heavy Duty Crossbar
SUH -Vortex Crossbar