**READ ME !** 

Thank you for purchasing a Front Runner Volkswagen T5 & T6 Ladder.

Before you start, take a moment to familiarize yourself with the Fitting Instructions and the components received.

Refer to Page 2 for a list of all the components, quantities and tools required.

IMPORTANT WARNING! 

IT IS CRITICAL THAT ALL FRONT RUNNER PRODUCTS BE PROPERLY AND SECURELY ASSEMBLED AND ATTACHED TO YOUR VEHICLE. IMPROPER ATTACHMENT COULD RESULT IN AN AUTOMOBILE ACCIDENT, AND COULD CAUSE SERIOUS BODILY INJURY OR DEATH. YOU ARE RESPONSIBLE FOR ASSEMBLING AND SECURING ALL FRONT RUNNER PRODUCTS TO YOUR VEHICLE, CHECKING THE ATTACHMENTS PRIOR TO USE, AND PERIODICALLY INSPECTING THE PRODUCTS FOR ADJUSTMENT, WEAR AND DAMAGE. THEREFORE, YOU MUST READ AND UNDERSTAND ALL OF THE INSTRUCTIONS AND PRECAUTIONS SUPPLIED WITH YOUR FRONT RUNNER PRODUCT PRIOR TO INSTALLATION OR USE. IF YOU DO NOT UNDERSTAND ALL OF THE INSTRUCTIONS AND CAUTIONS, OR IF YOU HAVE NO MECHANICAL EXPERIENCE AND ARE NOT THOROUGHLY FAMILIAR WITH THE INSTALLATION PROCEDURES, YOU SHOULD HAVE THE PRODUCT INSTALLED BY A PROFESSIONAL INSTALLER OR OTHER QUALIFIED PERSONNEL.

NOTE: Front Runner will not be responsible for any damage caused by the failure to install the product according to these instructions.

Please call us if you have any questions about the installation of this product.

1

GET ORGANIZED

IN THE BOX

1	1 X	T5 - Ladder Top Mount
2	1 X	T5 - Pinch Bracket
3	1 X	T6 - Ladder Top Mount
4	1 X	T6 - Pinch Bracket
5	56 X	M6 Flat Washer
6	6 X	M6 Spring Washer
7	6 X	M6 x 20 Button Head Screw
8	1 X	Top RH Ladder Side
9	20 X	M6 x 16 Button Head Screw
10	2 X	Ladder Joining Plate
11	1 X	RH Ladder Joining Bracket
12	1 X	Bottom RH Ladder Side
13	3 X	Ladder Rung
14	1 X	Fixing Plate Assembly
15	10 X	M6 Nut Cap
16	30 X	M6 Nyloc Nut
17	1 X	Bottom LH Ladder Side
18	1 X	LH Ladder Joining Bracket
19	2 X	Angled Ladder Rung
20	1 X	Top LH Ladder Side
21	3 X	Jack Nut
22	2 X	45mm Rubber Strip
23	2 X	M6 x 30 Button Head Screw
24	1 X	Jack Nut Tool

TOOLS NEEDED



10mm



4mm



10mm



T50



6.5mm
12mm



Marking Pen



Scissors



Masking
Tape



Anti-Rust



Denatured
Alcohol

FIGURE 1.1

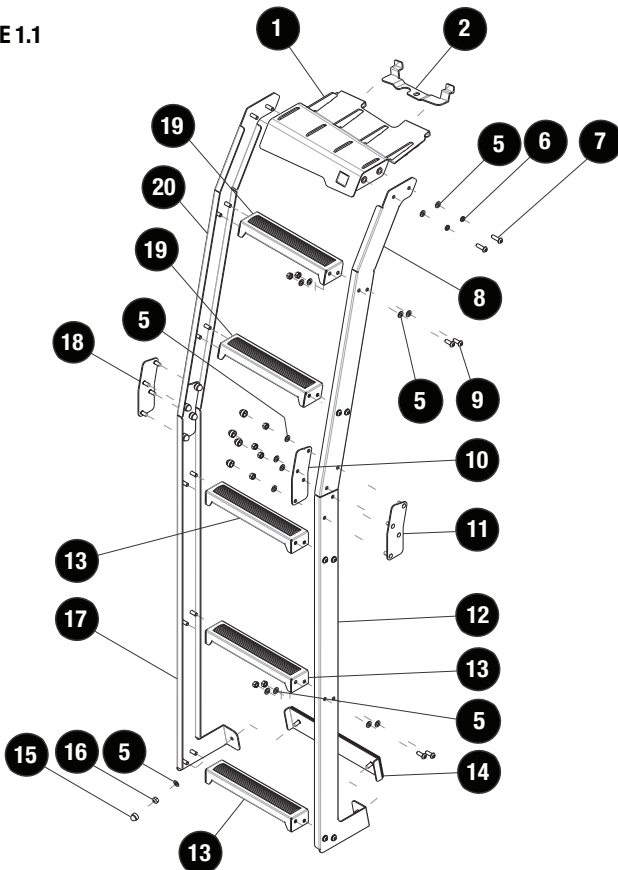

T6 - LADDER TOP MOUNT & PINCH BRACKET

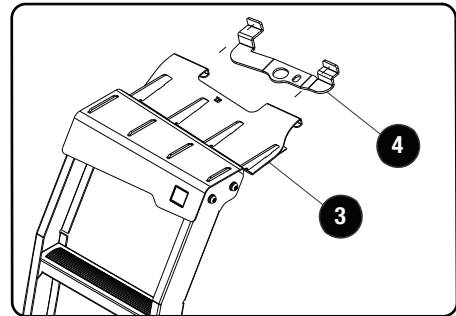

! PERMANENT FITMENT - Drilling required

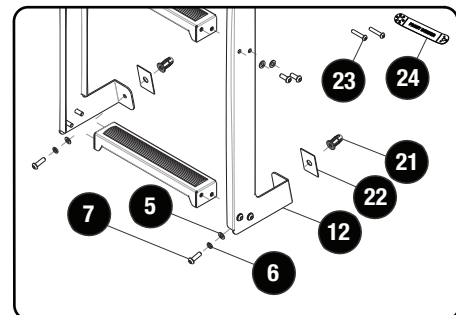

2

PREPARE

2.1

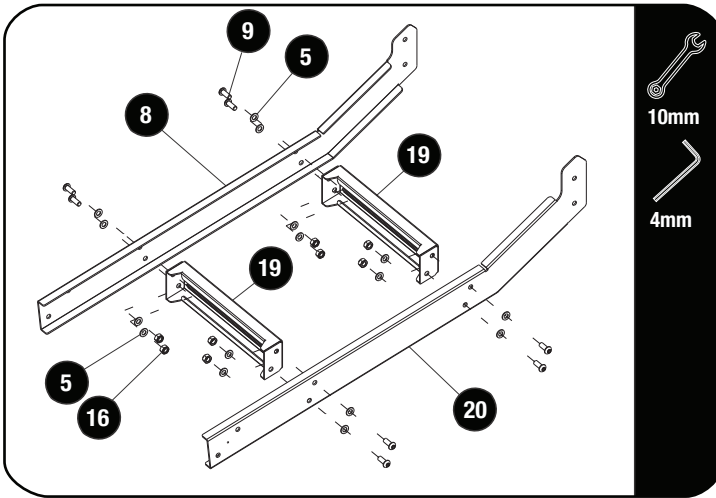

Secure the two Angled Ladder Rungs (Item 19) to the Top RH Ladder Side (Item 8) and the Top LH Ladder Side (Item 20) using eight M6 x 16 Button Head Screws, sixteen M6 Flat Washers and eight M6 Nyloc Nuts (Item 9, 5 & 16).

2.2

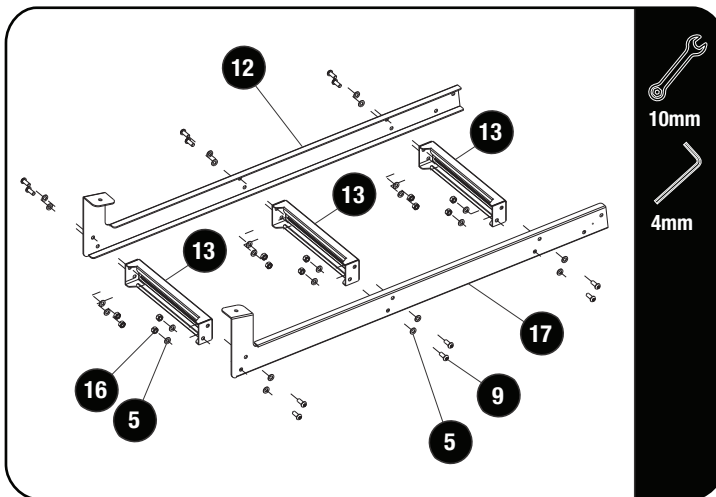

Secure the three Ladder Rungs (Item 13) to Bottom RH Ladder Side (Item 12) and Bottom LH Ladder Side (Item 17) using twelve M6 x 16 Button Head Screws, twenty four M6 Flat Washers and twelve M6 Nyloc Nuts (Item 9, 5 & 16).

2.3

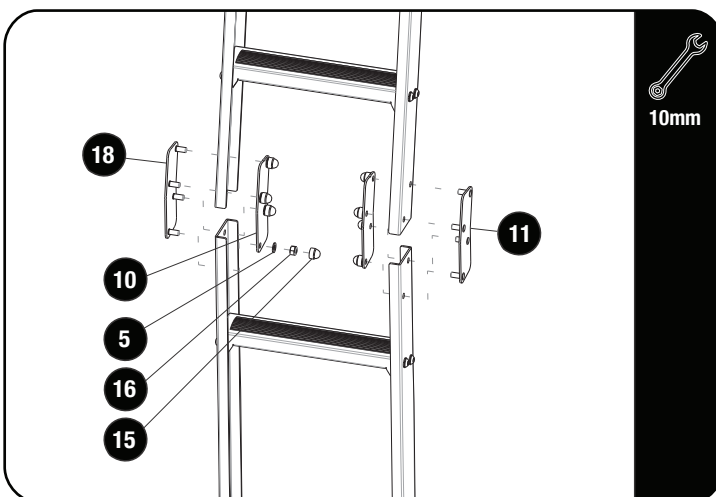

Secure the top assembly to the bottom assembly using the RH Ladder Joining Bracket (Item 11), LH Ladder Joining Bracket (Item 18) and two Ladder Joining Plates (Item 10) with eight M6 Flat Washers, eight M6 Nyloc Nuts (Item 5 & 16). Finish off by placing eight M6 Nut Caps on the M6 Nyloc Nuts (Item 15).

2

PREPARE

2.4

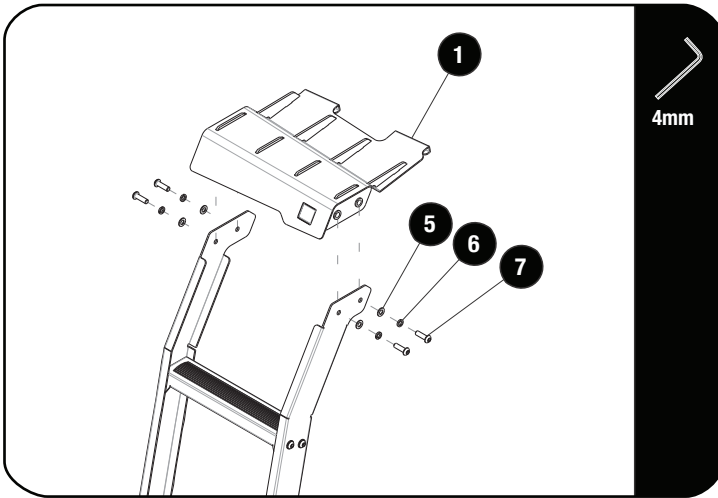

T5 - VEHICLE FITMENT



Secure the T5 - Ladder Top Mount (Item 1) to the assembled Ladder using four M6 x 20 Button Head Screws, four M6 Spring Washers and four M6 Flat Washers (Item 7, 6 & 5).



CONTINUE TO 2.6

2.5

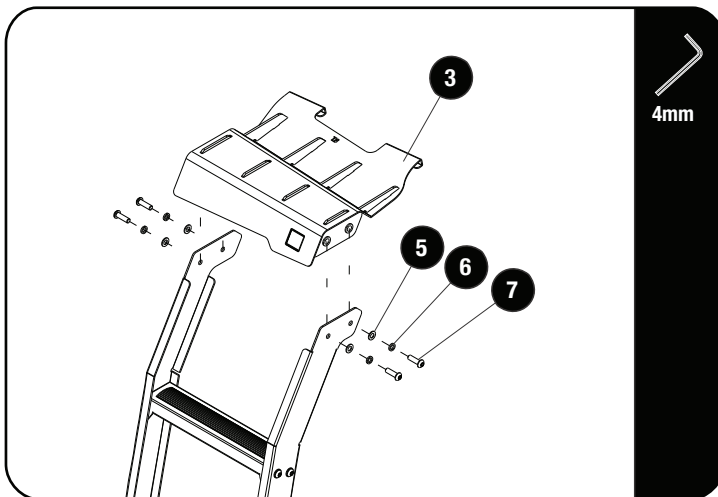

T6 - VEHICLE FITMENT



Secure the T6 - Ladder Top Mount (Item 3) to the assembled Ladder using four M6 x 20 Button Head Screws, four M6 Spring Washers and four M6 Flat Washers (Item 7, 6 & 5).

2.6

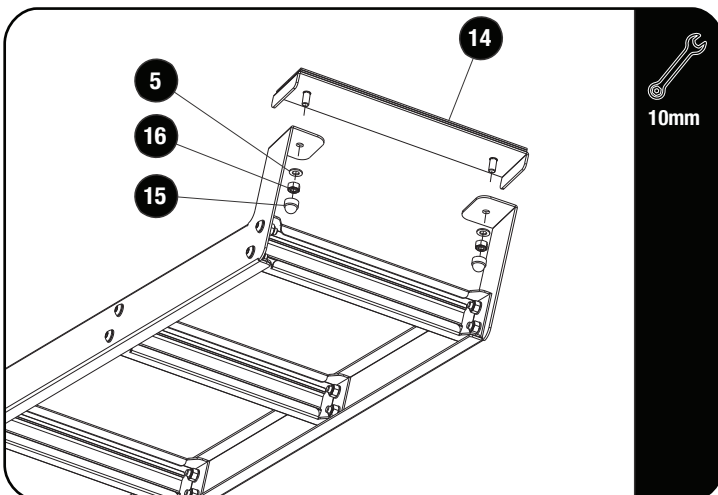

FOR PERMANENT FITMENT, SKIP THIS STEP AND CONTINUE TO 2.7.



Secure the Fixing Plate Assembly (Item 14) to the bottom of the ladder using two M6 Flat Washers and two M6 Nyloc Nuts (5 & 16). Finish off by placing two M6 Nut Caps on the M6 Nyloc Nuts (Item 15).

2

PREPARE

2.7

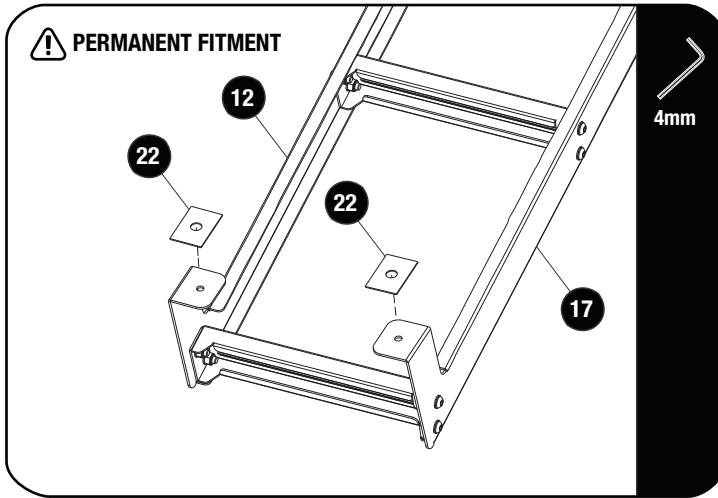

Remove the backing tape from the 45mm Rubber Strip (Item 22) and secure it to the bottom tabs on Bottom RH Ladder Side (Item 12) and Bottom LH Ladder Side (Item 17), aligning the hole in the 45mm Rubber Strip with the holes in both bottom tabs.

3

FIT AND SECURE

3.1

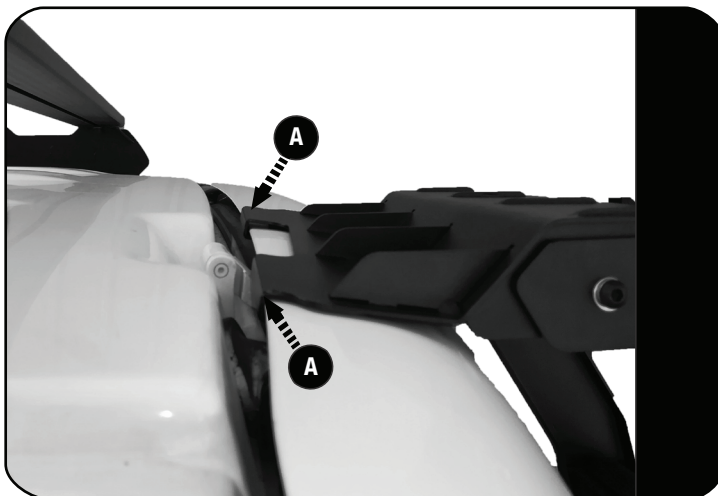

! T5 - VEHICLE FITMENT

Hook the T5 - Ladder Top Mount (Item 1) over the top edge of the Rear Door.

A Pull the top lip against the top edge of the rear door and rest let the ladder on the vehicle as shown.

! Insure rubber strip is placed under the bracket.

3

FIT AND SECURE

3.2

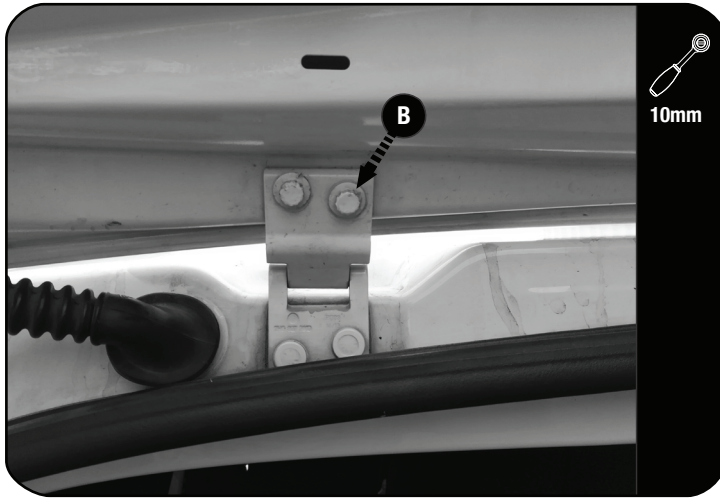

T5 - VEHICLE FITMENT

Carefully open the rear door. Do not let the rear door swing open.



Loosen and remove the right hand screw on the left hand door hinge.

3.3



T5 - VEHICLE FITMENT



Ensure the top mount hooks from the Ladder are against the top edge of the rear door. Place the T5 - Pinch Bracket (Item 2) over the top mount hooks, lining up the slotted hole in the Pinch Bracket with the screw hole. Center the ladder between the Pinch Bracket clamps.

Secure the Pinch Bracket to the vehicle using the screw removed. Fully tighten.



Carefully close the rear door.



CONTINUE TO 3.7

3.4

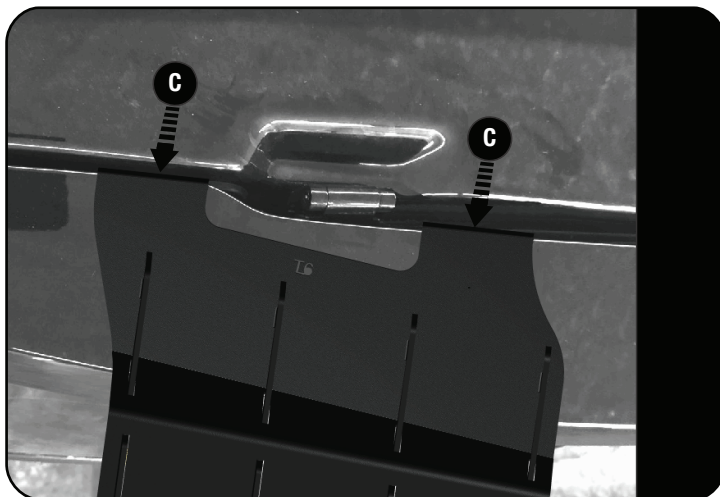

T6 - VEHICLE FITMENT



Hook the T6 - Ladder Top Mount (Item 3) over the top edge of the Rear Door.



Pull the top lip against the top edge of the rear door and let the ladder rest against the vehicle.



Insure rubber strip is placed under the bracket.

3 FIT AND SECURE

3.5

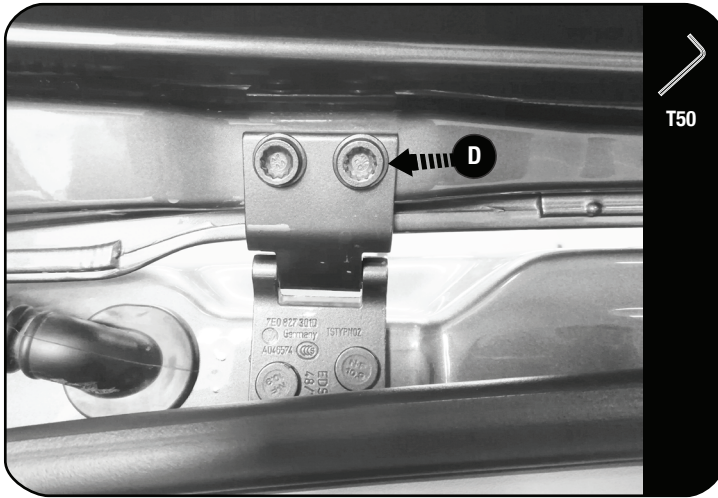

T6 - VEHICLE FITMENT

Carefully open the rear door. Do not let the rear door swing open.

- D** Loosen and remove the right hand screw on the left hand door hinge.

3.6



T6 - VEHICLE FITMENT

- Ensure the top mount hooks from the Ladder are against the top edge of the rear door. Place the T6 - Pinch Bracket (Item 4) over the top mount hooks, lining up the slotted hole in the Pinch Bracket with the screw hole and the large clearance hole over the left hinge bolt. Position the ladder between the T6 - Pinch Bracket clamps as shown.

Secure the Pinch Bracket to the vehicle using the screw removed. Fully tighten.

- Carefully close the rear door.

3.7

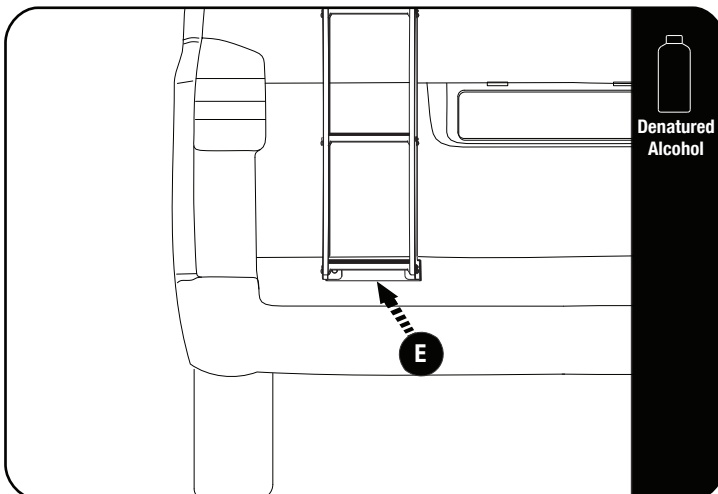

FOR PERMANENT FITMENT, SKIP THIS STEP AND CONTINUE TO 3.7.

Use Denatured Alcohol and insure the door is clean from any residue where the bottom of the Ladder rests against the door.

- E** Remove the backing from the Dual Lock Velcro at the bottom of the Ladder and firmly push the bottom of the Ladder against the body of the vehicle.

3

FIT AND SECURE

3.8

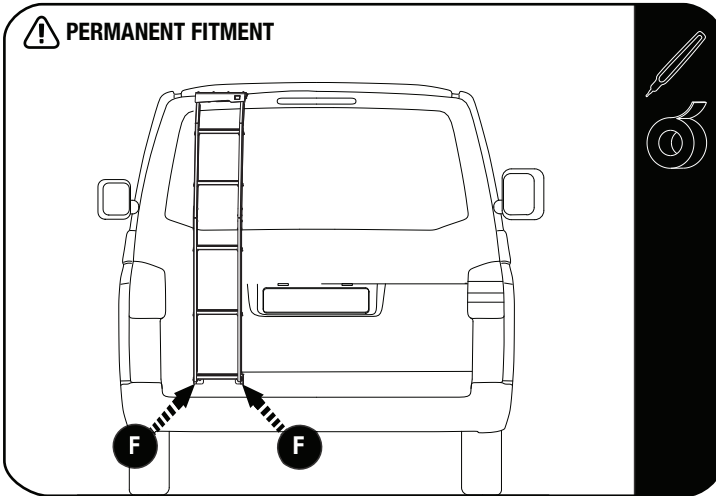

F Apply masking tape to the door where the ladder is resting against the door. Mark the position of the bottom holes using the bottom ladder tab holes as a reference. Remove the Ladder.

3.9

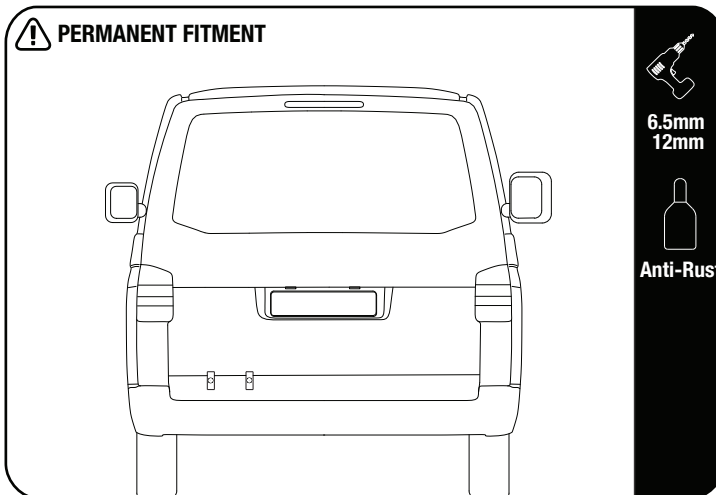

Using a 6.5mm drill bit, drill a pilot hole in the center of each of your markings. Open the holes using a 12mm drill bit. Only drill through the first outer skin of the door. Remove the masking tape and apply some Anti Rust on the exposed metal of each hole.

3.10

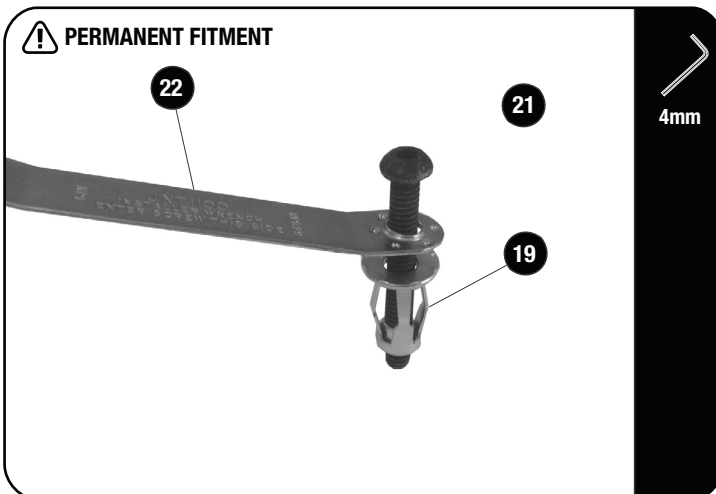

Insert the M6 x 30 Button Head Screw (Item 21) into the one side of the Jack Nut Tool (Item 22). Loosely fit a Jack Nut (Item 19) to the M6 x 30 Button Head Screw (Item 21) as shown. Place the assembly into the hole drilled in 3.6. Using a 4mm Allen Key, insert the Jack Nut (Item 19) into the hole while holding the Jack Nut Tool (Item 22) firmly and tighten the M6 x 30 Button Head Screw (Item 21) to pull the Jack Nut (Item 19) up against the inside of the vehicle.

Make sure the Jack Nut has pulled up all the way to the inside skin of the door panel

A Corded/Cordless Drill with a H4 Bit can also be used. Care must be taken not to damage the screw head.

3

FIT AND SECURE

3.11

 PERMANENT FITMENT

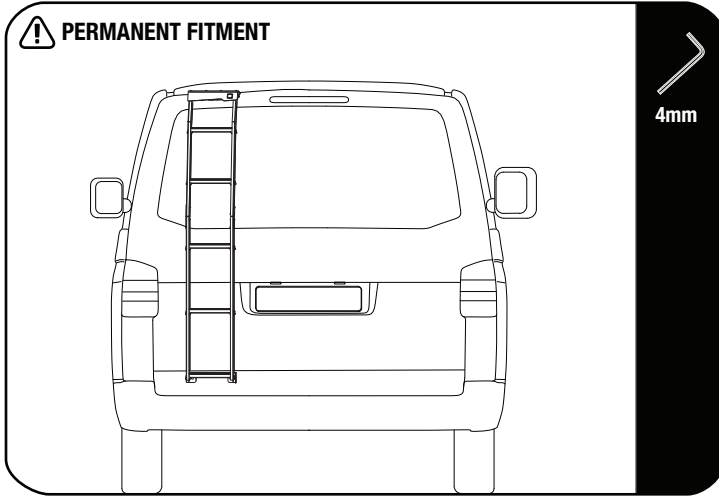

4mm



Repeat steps from 3.1 and refit the Ladder to the door.

Secure the bottom of the Ladder to the door using two M6 x 20 Button Head Screws, two M6 Spring Washers and two M6 Flat Washers (Items 5, 4 & 3).

4

FINISH

Congratulations! You did it. Take a step back and admire your work!

5

INSTALL OTHER VEHICLE AND RACK ACCESSORIES

Now's the time to visit your favorite Front Runner Dealer in person or online.

Be sure to tag us. We love to see our gear in action! #FrontRunnerOutfitters #BornToRoam

Share your adventures on: 