

READ ME !

Thank you for purchasing a Front Runner Roof Rack Mounting System.
Before you start, take a moment to familiarize yourself with the Fitting Instructions and the included components.
Refer to Page 2 for a list of all the components, quantities and tools required.

IMPORTANT WARNING!

IT IS CRITICAL THAT ALL FRONT RUNNER PRODUCTS BE PROPERLY AND SECURELY ASSEMBLED AND ATTACHED TO YOUR VEHICLE. IMPROPER ATTACHMENT COULD RESULT IN AN AUTOMOBILE ACCIDENT, AND COULD CAUSE SERIOUS BODILY INJURY OR DEATH. YOU ARE RESPONSIBLE FOR ASSEMBLING AND SECURING ALL FRONT RUNNER PRODUCTS TO YOUR VEHICLE, CHECKING THE ATTACHMENTS PRIOR TO USE, AND PERIODICALLY INSPECTING THE PRODUCTS FOR ADJUSTMENT, WEAR AND DAMAGE. THEREFORE, YOU MUST READ AND UNDERSTAND ALL OF THE INSTRUCTIONS AND PRECAUTIONS SUPPLIED WITH YOUR FRONT RUNNER PRODUCT PRIOR TO INSTALLATION OR USE. IF YOU DO NOT UNDERSTAND ALL OF THE INSTRUCTIONS AND CAUTIONS, OR IF YOU HAVE NO MECHANICAL EXPERIENCE AND ARE NOT THOROUGHLY FAMILIAR WITH THE INSTALLATION PROCEDURES, YOU SHOULD HAVE THE PRODUCT INSTALLED BY A PROFESSIONAL INSTALLER OR OTHER QUALIFIED PERSONNEL.

NOTE: Front Runner will not be responsible for any damage caused by the failure to install the product according to these instructions.
Please call us if you have any questions about the installation of this product.



1 GET ORGANIZED

IN THE BOX

1	1 X	Support Bar Weld Assembly LH
2	1 X	Bracket Weld Assembly LH
3	1 X	Bracket Weld Assembly RH
4	1 X	Support Bar Weld Assembly RH
5	1 X	Inner Bracket LH
6	1 X	Inner Bracket RH
7	4 X	30 X 6 X 2 Washer (Black)
8	4 X	M6 X 50 Button Head Screw
9	6 X	M8 X 25 Button Head Screw
10	4 X	Spacer 19 X 12.5 X 15
11	4 X	M8 X 20 Hex Bolt
12	8 X	M8 Nyloc Nut
13	4 X	M8 X 16 X 1.6SS Flat Washer

IN THE BOX

14	2 X	Double Side Tape (100mm)
15	8 X	M8 X 19 X 2 Flat Washer
16	4 X	M8 X 20 Button Head Screw
17	2 X	38mm Round Ribbed Insert

TOOLS NEEDED

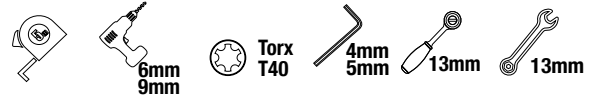
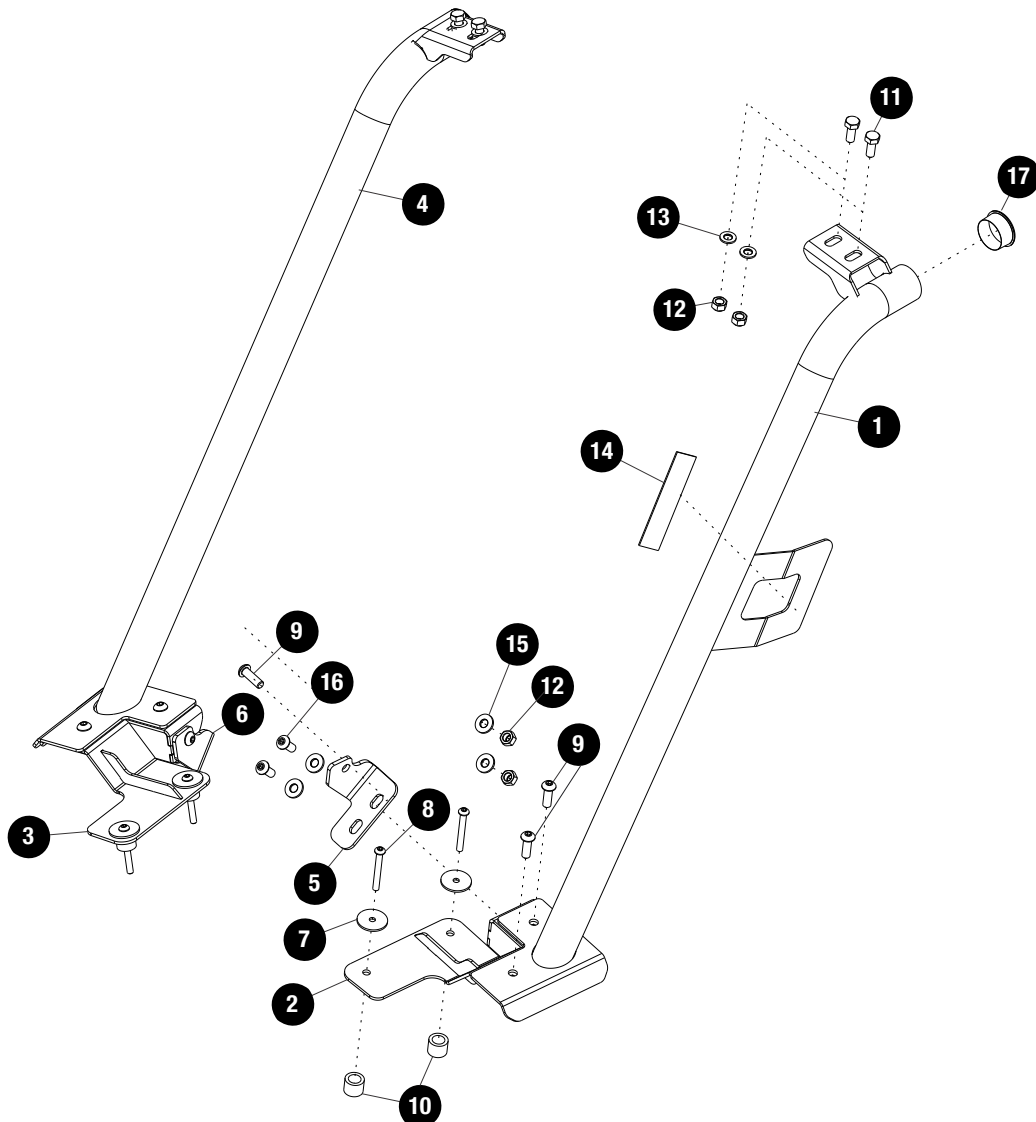

FIGURE 1.1



2

FIT AND SECURE

2.1

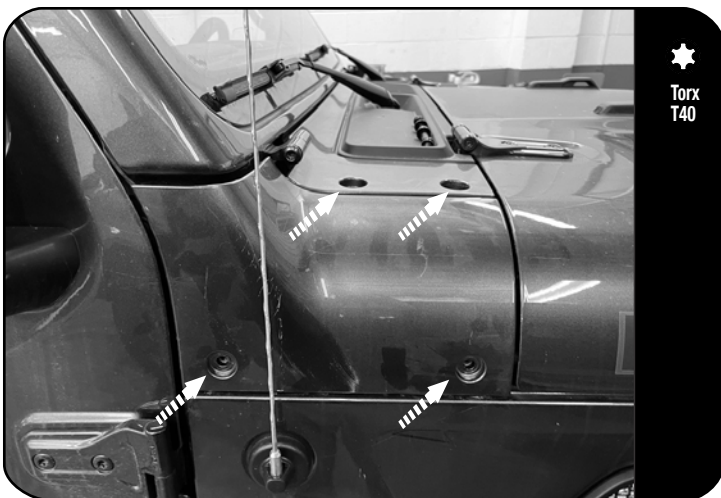

Using a T40 Torx driver, remove the 4 bolts securing the cowling cover as shown.

2.2

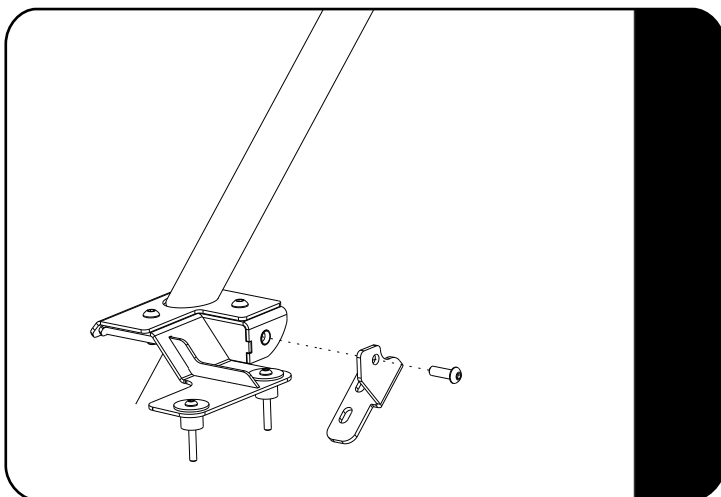

Loosely fit the inner bracket (item 5) to the bracket weld assembly (item 1) and support bar (item 1). Place the assembly over the top 2 mounting points (10) shown below in 2.3 and fit the two bolts (item 8). Angle the bar so that it is parallel to the door shut line as in 2.4.

2.3

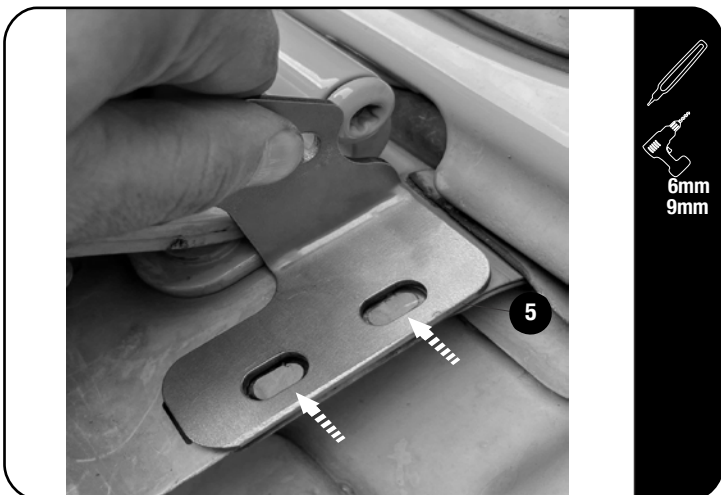

Mark the bracket position (Item 5). Remove the assembly and position only the inner bracket (Item 5) on the marks you made. Mark the slot centers in the bracket and drill a 6mm pilot hole, open the holes using a 9mm drill.

Fit the bracket (Item 5) as shown in 2.2 and fully tighten.

Do the same on the opposite side of the vehicle.

2

FIT AND SECURE

2.4

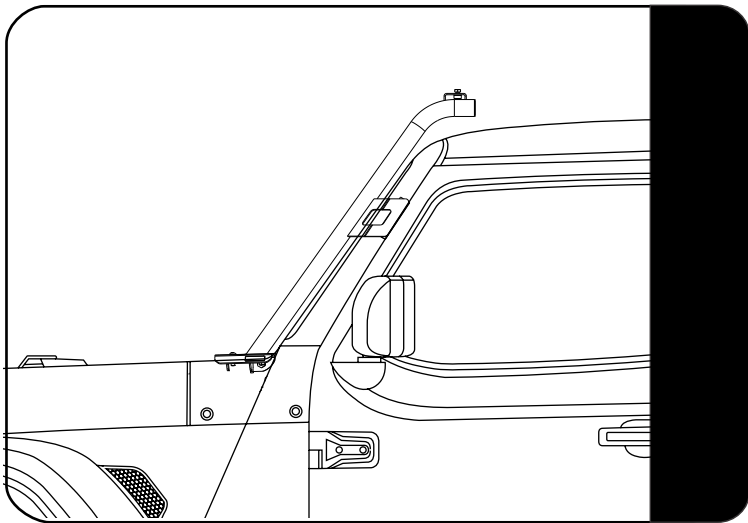

↻ Angle the bar so that it is parallel to the door shut line.

2.5



↻ Refit the cowling cover and place the spacers (item 10) in the top two recesses as shown.

2.6

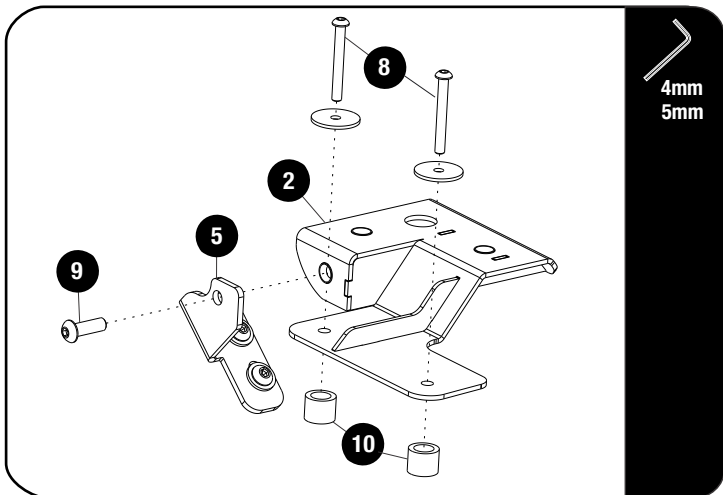



↻ With the Inner Bracket secured in place, Assemble the Bracket Weld Assembly (Item 2) to the Inner Bracket as shown using the M8 X 25 Button Head Screw (Item 8). Insure the spacers are in place (See 2.2) before placing the M6 X 50 Button Head screws and the 30 X 6 X 2 flat washer (Item 7 & 8) into the mounting holes DO NOT FULLY TIGHTEN.

2

FIT AND SECURE

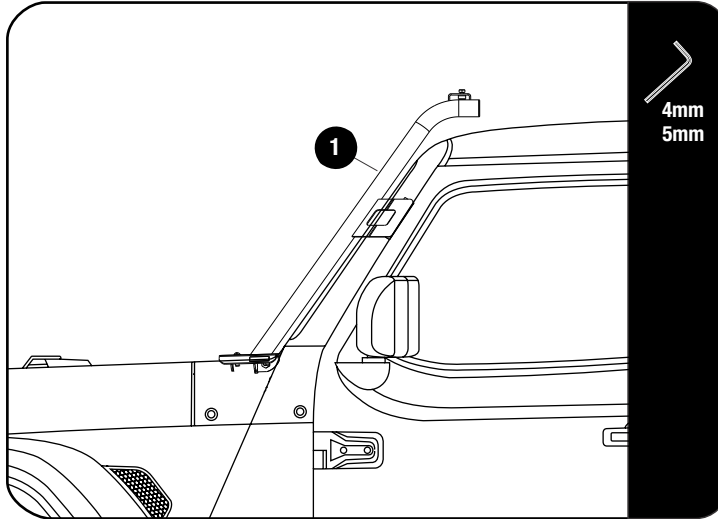
2.7





Insure A pillar is clean and free from grease!
 With the Bracket (Item 2) installed, place the Support Bar LH (Item 1) over the Bracket (Item 2) as shown and secure using M8 X 25 Button Head Screw (Item 9). Fully tighten the M8 Button Head bolts (Item 9) and then the M6 Button Heads (Item 8) on the top.
 Remove the VHB tape backing strip taking care not to touch the A pillar. Align the bar with the door shut line. The bracket edge should be +/- 5mm from A pillar edge. Once aligned firmly press the bar against the A pillar and hold for a few seconds
TIP : In colder climates heat the tape with a heat gun to ensure a proper bond
 Repeat steps 2.1 - 2.4 on the opposite side of vehicle with the other bracket and bar.



Tightening Torque:

M8 : 15-20Nm / 11.06 ft lb - 14.75 ft lb
 M6 : 8-10Nm / 5.9 ft lb - 7.38 ft lb

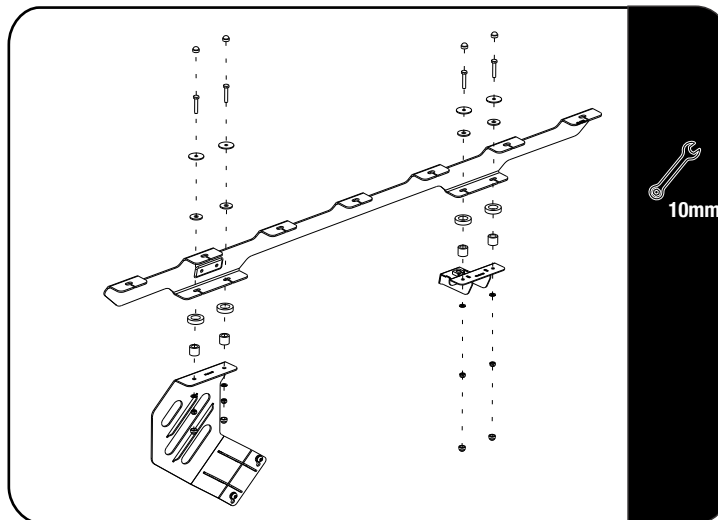
2.8



Before moving to the next step you need to install the Inner and Middle Support Brackets.
 Refer to FAJL002 & FAJL003 Fitment Guides.

2.9

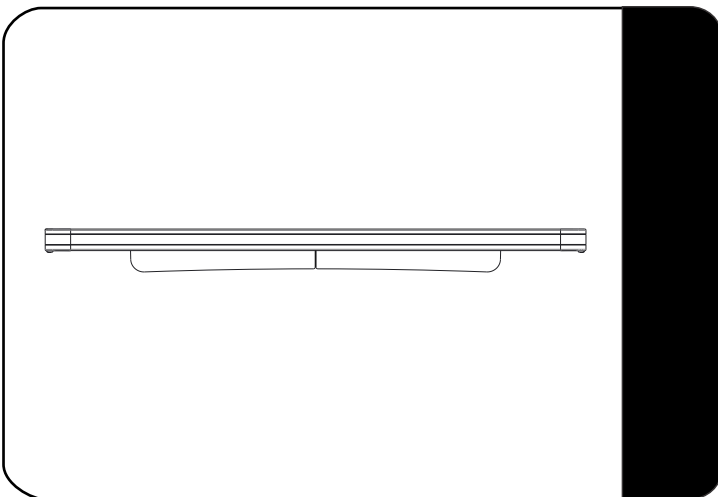



Assemble your Tray as per the Universal Tray Assembly Instructions.
Make sure that the wind deflector is installed before you proceed to the next step.

2

FIT AND SECURE

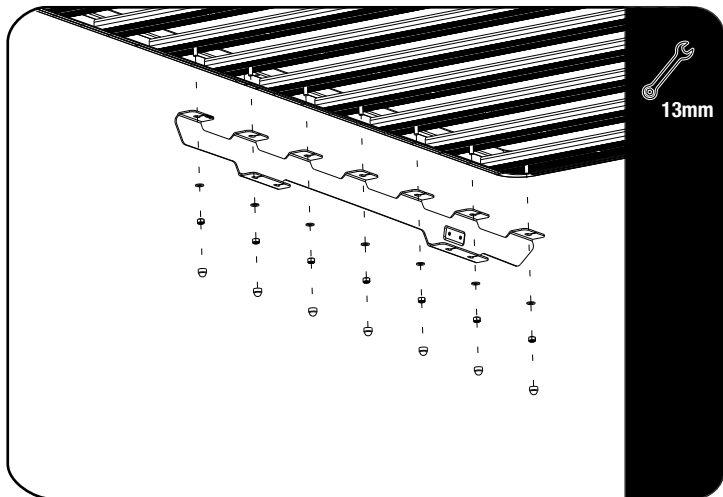
2.10



With the help of a friend place the rack onto the rails and brackets. Position all the bolts so that they drop through foot rail slots and the front mount bars. Center the rack.

Refer to FAJL002 & FAJL003 Fitment Guides.



Tightening Torque:

M8 : 15-20Nm / 11.06 ft lb - 14.75 ft lb

2.11

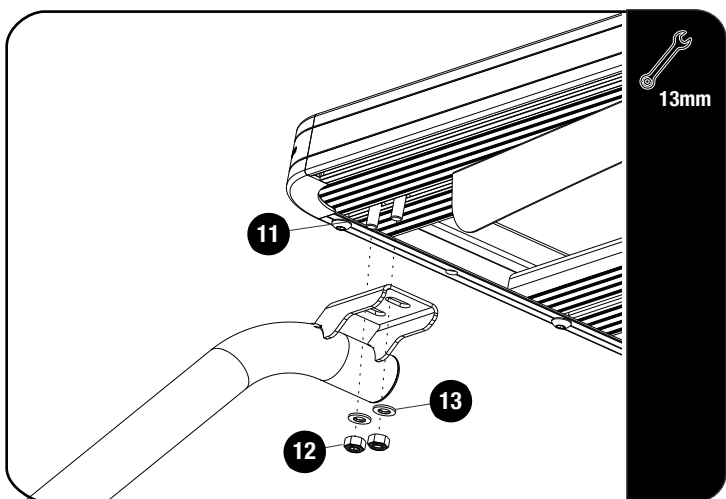

When you get to the front bars, check support bar alignment with door shut line before tightening to the rack. (The top has slots and will allow it to be adjusted).

Push the bar inward against the A pillar. While holding it in place fully tighten the Top nuts to secure the rack. Do this with both front bars.

Fully tighten all M8 Nyloc nuts

Finish off by placing nut caps over all nuts.

3

FINISH

Congratulations! You did it. Take a step back and admire your work!

4

INSTALL OTHER VEHICLE AND RACK ACCESSORIES

Now's the time to visit your favorite Front Runner Dealer in person or online.

Be sure to tag us. We love to see our gear in action! #FrontRunnerOutfitters #BornToRoam

Share your adventures on: 