



INSTALLATION INSTRUCTIONS

Rear Bumper

Part Number: 106300

Application: JT Jeep Gladiator

GENERAL SAFETY PRECAUTIONS

Your safety, and the safety of others, is very important. To help you make informed decisions about safety, we have provided installation and operating instructions and other information on labels and in this guide. This information alerts you to potential hazards that could hurt you or others. It is not possible to warn you about all potential hazards associated with this product, you must use your own good judgment.

CARELESS INSTALLATION AND OPERATION CAN RESULT IN SERIOUS INJURY OR EQUIPMENT DAMAGE. READ AND UNDERSTAND ALL SAFETY PRECAUTIONS AND OPERATING INSTRUCTIONS BEFORE INSTALLING AND OPERATING THIS PRODUCT.

This guide identifies potential hazards and has important safety messages that help you and others avoid personal injury or death. WARNING and CAUTION are signal words that identify the level of hazard. These signal words mean:

▲WARNING signals a hazard that could cause serious injury or death, if you do not follow recommendations. **▲CAUTION** signals a hazard that may cause minor to moderate injury, if you do not follow recommendations.

This guide uses **NOTICE** to call attention to important mechanical information, and Note: to emphasize general information worthy of special attention.

▲ WARNING

IMPACT AND MOVING PARTS ENTANGLEMENT HAZARD

Failure to observe these instructions could lead to severe injury or death

- **Always** Know Your Winch. Take time to fully read the Instructions and/or Operations Guide, and/or Basic Guide to Winching Techniques, in order to understand your winch and its operations.
- **Never** work under vehicle before properly securing vehicle.
- **Always** use appropriate and adequate care in lifting components into place.
- **Never** work under vehicle before properly securing vehicle.
- **Always** use appropriate and adequate care in lifting components into place.
- **Never** use a jack to support the vehicle.
- **Always** use jack stands in pairs to support the vehicle.
- **Always** use jacks or jack stands only on a hard, stable, and level surface.
- **Never** exceed the rated capacity of a jack or jack stands.
- **Always** verify that the parking brake is set, the transmission is in park (automatic) or reverse (manual) and the rear wheels are blocked before working on vehicle.
- **Never** work under vehicle before properly securing vehicle.
- **Always** use appropriate and adequate care in lifting components into place.
- **Always** insure components will remain secure during installation and operation.
- **Always** tighten all nuts and bolts securely, per the installation and operation.
- **Always** perform regular inspections and maintenance on the winch, winch mount and related hardware.
- **Always** replace all worn or damaged parts before operating.
- **Never** operate this WARN product with damaged or missing parts.
- **Always** use extreme caution when drilling on any vehicle. Make sure that all fuel lines, brake lines, electrical wires, and other objects are not punctured or damaged when / if drilling on the vehicle. Thoroughly inspect the area to be drilled (on both sides of material) prior to drilling, and relocate any objects that may be damaged. Failure to inspect the area to be drilled may result in vehicle damage, electrical shock, fire or personal injury.
- **Always** use extreme caution when cutting and trimming during fitting.
- **Always** wear safety glasses when installing this kit. A drilling operation will cause flying metal chips. Flying chips can cause eye injury.
- **Always** remove jewelry and wear eye protection.
- **Never** lean over battery while making connections.
- **Never** route electrical cables across any sharp edge, through or near moving parts, near parts that become hot.

Read installation and operating instructions thoroughly.

WARN INDUSTRIES, INC. 12900 S.E. Capps Road,
Clackamas, OR USA 97015-8903, 1-503-722-1200, FAX: 1-503-722-3000
Customer Service: 1-800-543-9276
Dealer Locator Service: 1-800-910-1122
International Sales/Customer Service: 1-503-722-3008
International Fax: 1-503-722-3005

⚠ CAUTION

MOVING PARTS ENTANGLEMENT HAZARD

Failure to observe these instructions could lead to minor or moderate injury

- Part edges may be sharp!
- Always use proper posture / lifting technique or get lifting assistance while handling and installing product.

Read installation and operating instructions thoroughly.

NOTICE

EQUIPMENT DAMAGE

- **Never** tow vehicle by attaching a tow bar to the eyelets on the bumper.
- Do not attach tow bars directly to the bumper. Damage to bumper may occur. WARN bumpers are not designed to be used for flat towing. Consult with the manufacturer of your tow bar system for the proper vehicle tow bar brackets..

Read installation and operating instructions thoroughly.

NOTES

- **The Grille Guard should be installed after the Semi-Hidden Kit has been fully installed.**

BEFORE YOU BEGIN



This product may interfere with driver assist systems such as adaptive cruise control and parking assist systems that have sensors or cameras installed in the bumpers or front grill area. If your vehicle is equipped with any of these systems or features, consult your vehicle owner's manual before installing this product. These systems may need to be disabled as a result of installing this product.



TABLE OF CONTENTS

Tools Required.....	page 2
Parts List.....	page 3
Torque Specifications.....	page 3
Installation.....	page 4
Maintenance/Care.....	page 4

TOOLS REQUIRED

- 13mm wrench
- 5mm Hex Key

PARTS LIST

Item	PN	Description	Qty.	Item	PN	Description	Qty.
A1	79456	M12X1.75 NUT	4	B1	106290	BUMPER	1
A2	79464	M12X1.75X25MBOLT	4				
A3	66261	M10X1.5 FLANGE NUT	4				
A4	100256	3/8 PUSH NUT BOLT	4				
A5	101857	M10-1.5X30 CARRIAGE BOLT	4				
A6	79077	M6-1.0X20MM FLANGE BOLT	2				
A7	83125	M6 X 1.0 FLANGE NUT	2				
A8	102248	PLUG	4				

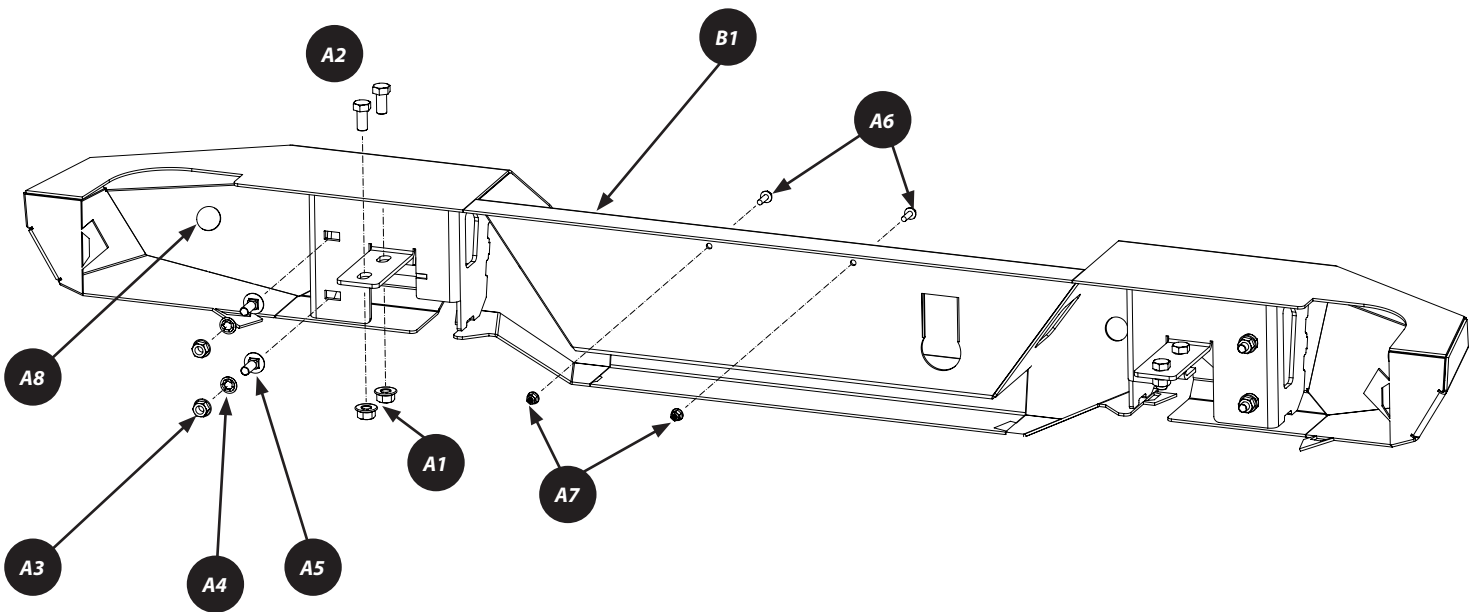

TORQUE SPECIFICATIONS

Please use the recommended torque specifications when assembling this product unless otherwise specified in the instructions.

FASTENER SIZE	FASTENER TORQUE		FASTENER SIZE	FASTENER TORQUE	
	lb-ft	(N.m)		lb-ft	(N.m)
1/4"	8	(11)	M4	(2)	3
5/16"	17	(23)	M5	(4.5)	6
3/8"	30	(40)	M6	(7.5)	10
7/16"	48	(66)	M8	(18)	25
1/2"	74	(100)	M10	(37)	50
9/16"	106	(144)			
5/8"	148	(200)			
3/4"	269	(364)			

INSTALLATION INSTRUCTIONS

1. Disconnect the rear bumper electrical harnesses, located along the inside of the frame rails on either of the spare tire.

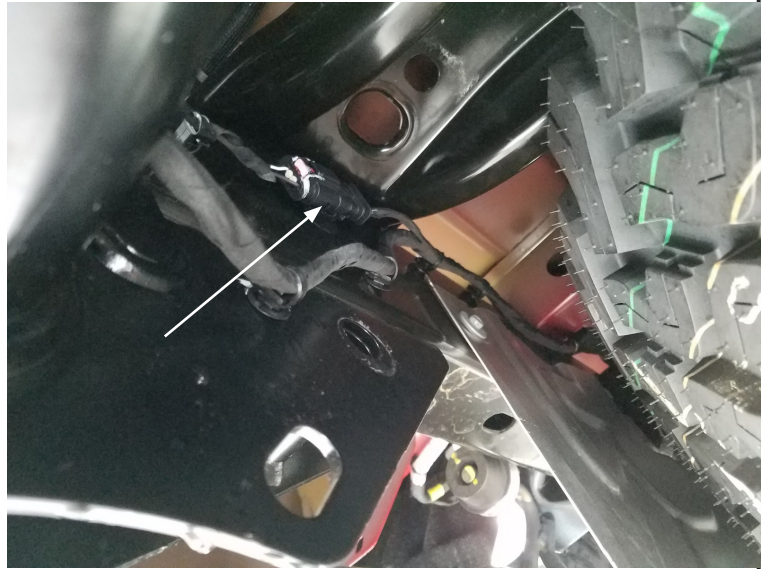

Figure 1

2. If equipped, remove the three bolts retaining the rear slider reinforcement to the side of the frame rails (each side).



Figure 2

3. If equipped, fully remove the rear sliders from the vehicle by removing the two bolts connecting the slider to the rear bumper (each side).
4. For all models, remove the two bumper nuts retaining the rear bumper to the frame pads (each side).

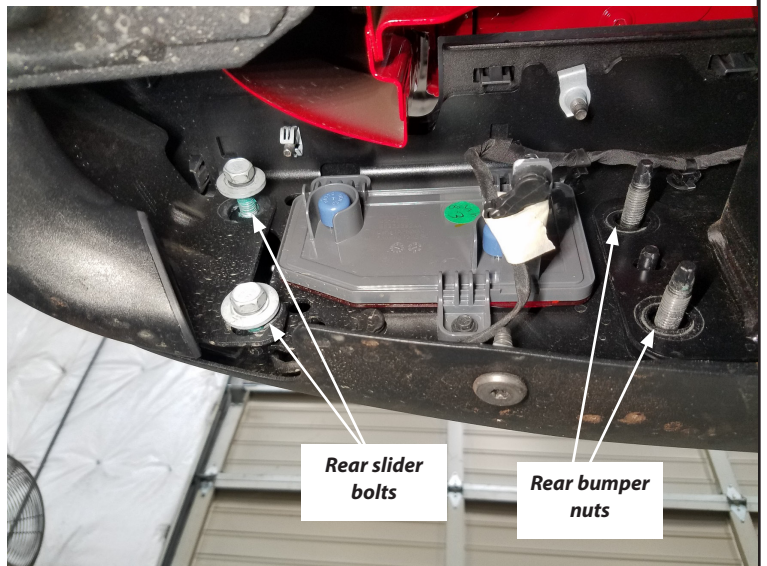

Figure 3

INSTALLATION INSTRUCTIONS

5. From the back of the trailer plug, unplug harness.
6. From the outside of the bumper, remove the trailer plug by depressing the tabs on the sides of the plug.
7. Remove the two bolts located behind the license plate.
8. With assistance remove the bumper from the vehicle.

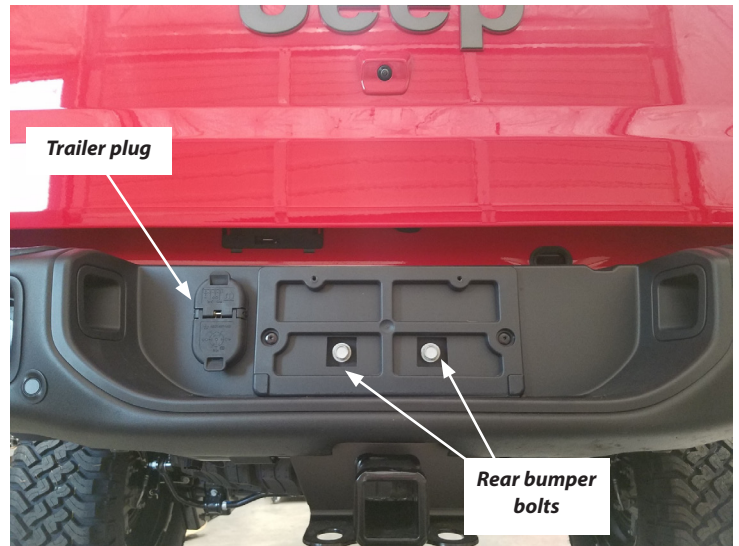

Figure 4

9. Remove the bolts retaining the tow hooks to the frame.



Figure 5

9. Remove the light housing from the bumper and retain it to be installed in the new bumper.



Figure 6

INSTALLATION INSTRUCTIONS

10. Remove the parking sensors from the bumper:
 - a. Unplug the harness from the sensors.
 - b. Remove the harness from the bumper.
 - c. Remove the parking sensors and carriages from the bumper.

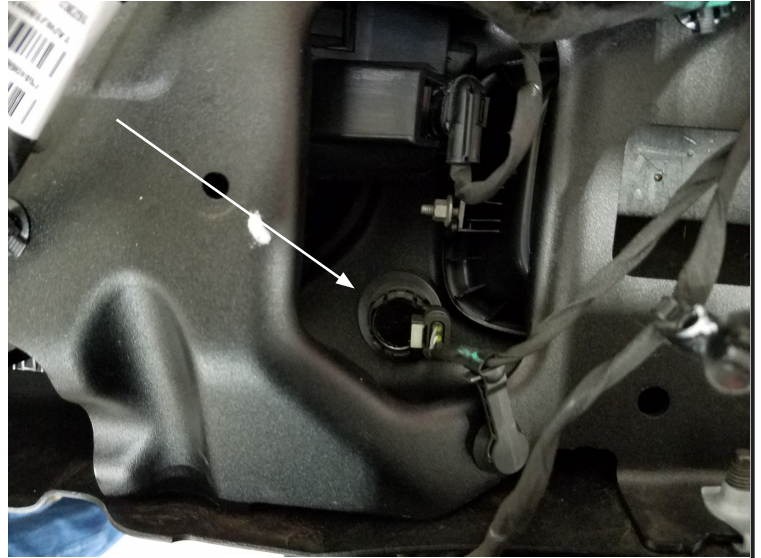

Figure 7

11. Install the provided carriage bolts (A5) into the slots on the Warn bumper mounting pads and secure in place with provided push nuts (A4).



Figure 8

12. With assistance, hang the bumper onto the rear frame pads using the previously installed carriage bolts and install nuts (A3) onto the carriage bolts (four total). Do not fully tighten.
13. Install the provided frame mount bolts (A2) through the frame and in the stock tow point mounting location.
14. Fully tighten ALL hardware.

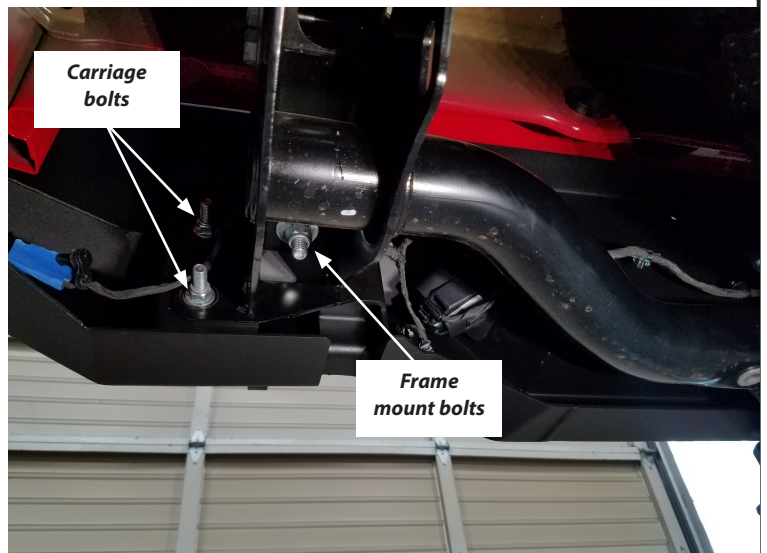

Figure 9

INSTALLATION INSTRUCTIONS

15. Reinstall the sensor plugs and license plate lights into the Warn bumper being sure to maintain the same orientation and location from the stock bumper.

NOTE: The locating tabs on carriages may need to be removed for proper fitment.

NOTE: For a cleaner fit of the inner two sensors, purchase a set of the outer carriages for the inner sensors to fit in. Contact your dealer for Jeep PN.



Figure 10

16. Reinstall the trailer plug into the Warn bumper and reattach all harnesses.



Figure 11

Installation is complete.



Figure 12

MAINTENANCE / CARE

1. Inspect all parts on the winch, winch mount, and related hardware prior to each use. Replace all hardware that appears rusted or deformed.
2. Inspect all nuts and bolts on the winch, winch mount, and related hardware prior to each use. Tighten all nuts that appear to be loose. Stripped, fractured, or bent bolts or nuts need to be replaced.
3. Check all cables prior to use. Replace cables that look worn or frayed.
4. Check all moving or rotating parts. Remove debris that may inhibit the part from moving freely.